

Splashbacks & Wall Panels in High Gloss, Satin Finish, DigitalArt Printed, any colour & Filler EFX™

ISPS are contactable 7 days a week 9am till 9pm Mon to Fri & 11am till 9pm Sat & Sun servicing nationally.

Bonethane®, available in any colour & EFX. A Polymer based product & coating formula, crafted & customised modelling strength, flexibility & colour spectrums that are simply endless. **Bonethane® Premium** has a continuous service temperature of 120°C. Suitable for induction cook tops, maintain distance specifications, showers cubicles, wet areas, feature walls, hospitals, under bars, outdoors, does not split or crack when following cutting instructions, a breeze to work with.

IPA Acrylic Splashbacks has a continuous service temperature of 72°C. Light flexible, bringing style to any home or commercial environment. IPA Acrylic grade is used for feature walls & shower cubicles, underbars not suitable for any cook-top, use Vetropoly Toughened glass.

See our filler EFX™ endless designs mixing colour combinations, used as either a mosaic filler design creating length extension, bordering or as a feature wall. Custom designed with your specific mix of colour blend, coordinating colours in high gloss or satin finish. Our Premium Metallic Satin finish range is durable & great for table tops, perfect for kitchen tables & bench spaces. Be in control, choose your colour, choose BonethanePremium or IPA Acrylic all custom Australian made.

FEATURE & BENIFITS Bonethane® & IPA Acrylic™

- ▶ Bonethane® is DIY & cost effective. Premium Sheets do not split or crack when cutting or drilling.
- ▶ Bonethane® grades can be cut down with ease on site including power points & innovative angles.
- ▶ Bonethane® & IPA Acrylic is available in any colour, metallic & abstract EFX™. Can be colour matched up to 12% variation to your selected colour choice.
- ▶ Bonethane® is suitable for indoors, outdoors & most wet areas. Applied virtually anywhere you can imagine. Great for shower cubicles!
- ▶ Bonethane® grades installation is easy, fast with a visual reward in a matter of hours.
- ▶ IPA Acrylic™ grade require more attention when cutting & should not be confused with Bonethane Premium, both substrates cut, repair & handle heat differently. IPA has a hard wearing surface great for kicks, feature walls, showers, heavy trafficked areas.

- ▶ Easy to clean, warm soapy water & sponge, rinse residue. Bonethane® grades air dry & shine, no polishing necessary saving you cleaning time. Harsh cleaning agents, gone!
- ▶ Bonethane® grades can be placed over existing surfaces.
- ▶ Bonethane® grades come with GripTek backing, no need to coat walls a neutral colour or sanding of the backs of sheets.
- ▶ Bonethane Premium has better heat distribution than Acrylic grades of material. Burn test on You Tube Bonethane Premium Vs Acrylic Candle burn test a must see!
- ▶ Bonethane & IPA are a custom made to order DIY product. Order what you need in any colour, accessories also available. We can create your corporate colour & logos into our sheeting.
- ▶ On Bonethane Premium ISPS can double your Warranty, ask how.
- ▶ IPA Acrylic is great for commercial fit outs.

See our Bonethane installation on Youtube. We intentionally scratch Bonethane with industrial scissors and repair before your eyes in real time. *Bonethane Splashbacks*, everything else is just plastic™
Bonethane Splashbacks, the right choice™

View Bonethane Premium VS Acrylic on You tube



Step by Step Installation Guide

Step 1

Lay Bonethane® flat for first 3 hours prior to Installation. Ensure wall is level flush free from holes neutral in colour forming even flat surface for Bonethane™ placement. Use only led pencil for marking cut outs or cuts on back of sheet, coated side.



Step 2

Measure the outside perimeter of the wall. Length and height, allowing 1 to 2mm gap all around. For example if you: measure 500 height by 500 length your cut out area should be 498 x 498 (2mm). It is important that the 1 to 2mm gap is followed, allowing Bonethane™ to expand and contract. Also measure section for cut out.



Turn off Electricity from main switch!!!

Step 3:

On perimeter of Bonethane® allow a 1 to 2mm gap all around. The tile wedge will be placed around the perimeter of the mm gap once clear silicone is applied to back & placed upright, against wall. The tile wedge will hold Bonethane™ in place (more about this in STEP 8)



Step 4

It is important to place Bonethane® face down (masked side down) in preparation for cutting. The area for the preparation of cutting must be free of obstacles, on a solid flat, non slip surface, in a well ventilated, lit area. Ensure the Bonethane® sheet is firmly secure in preparation for cutting.

Step 5

Power hole cut outs vary on the power switch. The cut out should not be greater than the covering plate. An electrician will also need to connect electricity if you have extra outlets.

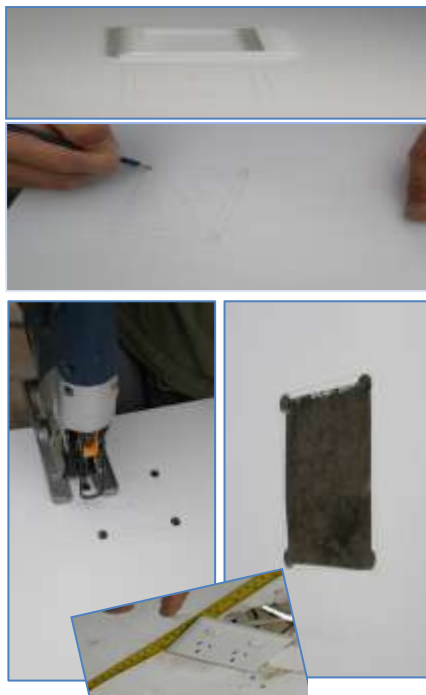

Step 6

Cut splash back once perimeter and cut out(s) measurements are final, making sure, Bonethane™ is face down, (that is the masked side is touching the flat level non slip surface and the coated side is facing you.



Step 7

After clear silicone grid process, mount Bonethane® onto wall, inserting cables through power hole cut outs, securing tile wedges around the 1 & 2mm allocated perimeter, leave tile wedges for approximately 2 hours. Clean surrounding areas free from saw dust particles. Once secure, peel off protective film from Bonethane® face. Please refer to "Care Do's" for keeping Bonethane® bright & beautiful



TIPS: Incorporate tiles as a design

DO NOT BUTT UP AGAINST GAS COOK TOPS

Step 8

Switch off Electricity for your safety!!! Add clear silicone to the coated side of Bonethane® (this is the side that does not have protective film), first vertically from the top then horizontally creating a grid of squares around 10 to 15 cm width and length ways.



Step 9

Finally use silicone clear non acidic to seal 2mm exposed joints & seal. Clear is always the safest choice, white is effective if you have a steady hand or you may seek the services of a professional. Follow instructions for silicone application, the product you choose should display instructions, make sure it is a water proof silicone used for kitchen and bathroom areas. When Bonethane® is upright & in a secure position peel off masking.



ISPS Innovations can provide a fire rated insert, custom made for behind your gas cook top. Made from Vetro Poly Star fire Toughened Glass in either metallic Silver or colour toned to blend with Bonethane® Premium or IPA Acrylic™. Please enquire about our glass offer call 08 8381 8880.



ISPS also customise trim in 6mm Anodised or Colour coded to finish your joints & Filler EFX.

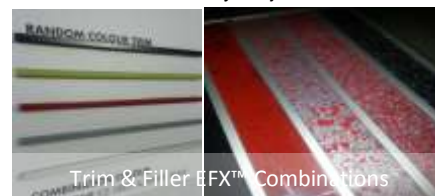

Trim & Filler EFX™ Combinations

Do not butt up against cook top

www.ispsinnovations.com.au

What you need Not included in Pack Jig saw fine sharp teeth to cut Premium & fine sharp plastic teeth blade for GN Acrylic grade. Drilling requires plastic drill bit attachment. The following items also required, tile wedges, silicone non acidic (Parfix neutral cure, all purpose clear silicone), protective goggles, dust mask, saws, spirit level. Call ISPS if in doubt 7 days a week.



Some of our standard Colour Range

Orange



Lime



Mushroom



Satin Blue



Pastel Plum

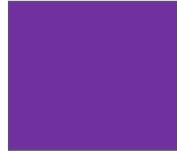

Ice Grey



Apple



A/White



Bone



Black



Satin Blue

BonethanePremium available in 16 standard Colours. The colours on this brochure vary from the actual colour. View display board in store for accurate colour. Call ISPS if you are unsure of colour



Apple Bonethane® Premium



A/White



Induction Cook-top



Retro Dusk Bonethane Premium & Silver VetroPoly™ Toughened Glass

Bonethane™ Splashbacks

ISPS
www.ispsinnovations.com.au
08 83818880



Grape



Ice Grey



Chocolate



Pick a colour



ISPS Green

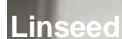
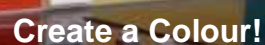



Hog Bristol Full Strength



Wasabinaise



Bonethane® Premium in Wendy's

Splashbacks & Wall Panels in High Gloss, Satin Finish, any colour & EFX

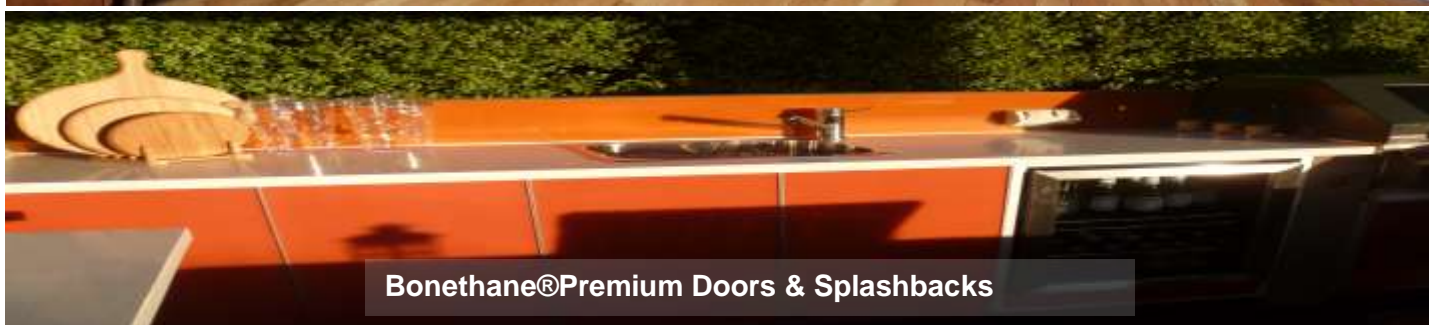

Bonethane® Premium Doors & Splashbacks

CUSTOM ORDER TO SPECIFICATION in Bonethane or IPA Acrylic.

For custom colour selection simply follow these steps:

1. Place your order with an ISPS team member, you may pay via credit card or EFT, you may wish to discuss cut to size options of which you must supply signed cutting list.
2. Choose grade of material.
3. Choose any colour sample either from our standard colour range, paint colour chips or another colour you may have ie (fabric), anything really. Additional charges can apply on colour matching, processes.
4. Post your colour chip to ISPS Innovations, Colour DEPT, PO Box 339 Lonsdale SA 5160. You will need to supply the colour chip for colour matching with all your details including your invoice or purchase order number supplied by ISPS.
5. Your custom coloured Bonethane, IPA products will be supplied in 10 to 12 work days.

Colour Toning Existing High Gloss Bonethane or IPA Grades

If you are extending, & require more Bonethane or IPA, ISPS Innovations can colour tone additional pieces for your project. What we require is a piece of Bonethane or IPA at least A4 to A3 size to be posted back to us, so we can process colour. We can have up to a 12% variation in colour toning gloss colours. If the gloss sample is too small we are limited in our colour process which can blow variation out to 25% & can effect pigment ratio. When colour matching satin colours we are dealing with one range of colour, when colour matching high gloss we need to factor in light contrast along with gloss depth. A small sample in gloss limits full colour range & variation up to 25% can occur. So the bigger the gloss sample the better the match.

TIPS & COLOURS: 1 to 6

- 1) When ordering multiple colours, it is best to order of same colour batch. Ordering off different batches can result in variations.
- 2) A/White on white can appear grey, so choose your white carefully, this may be a special order.
- 3) Bonethane Grades come with Griptek™ backing, no need to coat walls a neutral colour or sanding of the backs of sheets.
- 4) Adhesive, clear neutral cure silicone apply in grid format 10cm apart to sheet or wall.
- 5) Use standard jig saw with fine sharp teeth for cutting.
- 6) Use plastic cutting blade for IPA acrylic grades & plan cuts. Please call ISPS for tips & helpful information
- 7) Bonethane Premium is DIY friendly & will not split or crack when cutting & drilling with a jigsaw with fine sharp teeth.
- 8) When ordering from different colour batch through ISPS, please ensure an A3 or A4 gloss sample is provided.

Please refer to our colour section on our website for more information on colour process www.ispsinnovations.com.au

Note M2 rate applies to straight cut only. Additional charges apply for angles, elevated & power hole cut outs.

	Bonethane® Grade	Size	Item Number	Price Delivered
Petite 5mm	B/Premium™	400 X 1200MM	ISPSP01	
Slim 5mm	B/Premium™	400 x2440MM	ISPSP02	
SML 5mm	B/Premium™	1200 x 760MM	ISPSP03	
MED 5mm	B/Premium™	2440 x 600MM	ISPSP04	
STD 5mm	B/Premium™	2440 x 760MM	ISPSP05	
LGE 5mm	B/Premium™	2440 x1220MM	ISPSP06	
XL 5mm	B/Premium™	3000 x 760MM	ISPSP07	
XXL 5mm	B/Premium™	3000 x 900MM	ISPSP08	
XXXL 5mm	B/Premium™	3000 x 1100MM	ISPSP09	
CUT TO SIZE M2 RATE 5mm	B/Premium™	OVER 1.85M2	ISPSP10	
CUT TO SIZE M2 RATE 5mm	B/Premium™	UNDER 1.85M2	ISPSP11	
SML IPA 4.5 or 6mm	IPA Acrylic™	2440 X 600MM	ISPSP01	
STD IPA 4.5 or 6mm	IPA Acrylic™	3000 X 600MM	ISPSP02	
LGE IPA 4.5 or 6 mm	IPA Acrylic™	2440 X 1220MM	ISPSP03	
Shower Pack IPA 4.5 or 6mm	IPA Acrylic™	2 X 1M X2M SHEETS	ISPSP04	
CUT TO SIZE M2 RATE IPA	IPA Acrylic™ 4.5 or 6mm	OVER 1.85M2	ISPSP05	
CUT TO SIZE M2 RATE IPA	IPA Acrylic™ 4.5 or 6mm	UNDER 1.85M2	ISPSP06	
Colour Match Flat (solid colour not metallic)			ISPSC01	
Abstract EFX™			ISPSEFXC02	
Metallic			ISPSC03	
Printed Logo & colour backing with GripTek™	DigitalArt™ WP	Moq .500 x .500	ISPSP04	
Designer cut out & two tone Colour			ISPSP05	SBQ
Anodised Trim	TRIM	2400MM 6MMSOLID	ISPSP01	
Colour coded Trim	TRIM	2400MM 6MM SOLID	ISPSP02	
Cut to size 1 straight cut	OPTION	From 2440 x 1220 sheet	ISPSP03	
Cut to shape	OPTION	Up to 2440 x 1220 sheet	ISPSP04	
Power hole cut out	OPTION	1	ISPSP05	

Bonethane® Premium Sheets come with GripTek™ backing, IPA does not (OPTIONAL). The backing is a different colour to face of the sheet, if you require similar colour backing please advise the team member & ask that they place on your purchase order.

Universal Joining Strip for vertical or Horizontal Joins & Designer Filler EFX™ by ISPS Innovations

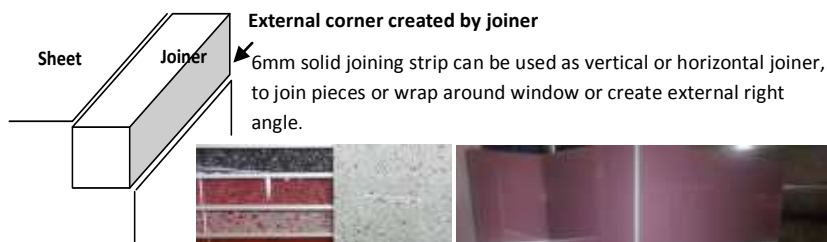
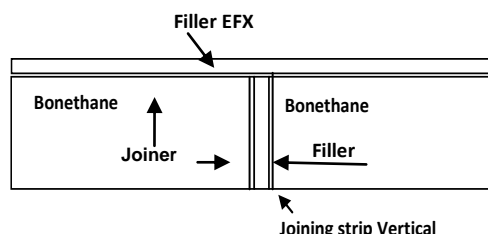

Filler EFX, custom designed. 65mm x 760mm. Longer lengths available. Additional charges apply.

Call 08 8381 8880 for more info.

NEW Bonethane®, Filler EFX™

A design based on the colour furnishings where Bonethane® is applied. Allowing the design to be placed horizontal or vertical within the sheet, housed with our anodised joiners. A stone or marble filler Efx™ creating the finishing touch based on your colour scheme. Bonethane® filler Efx™ fillers can also be used in conjunction with other products. Combination colours designed to your decor.

www.ispsinnovations.com.au

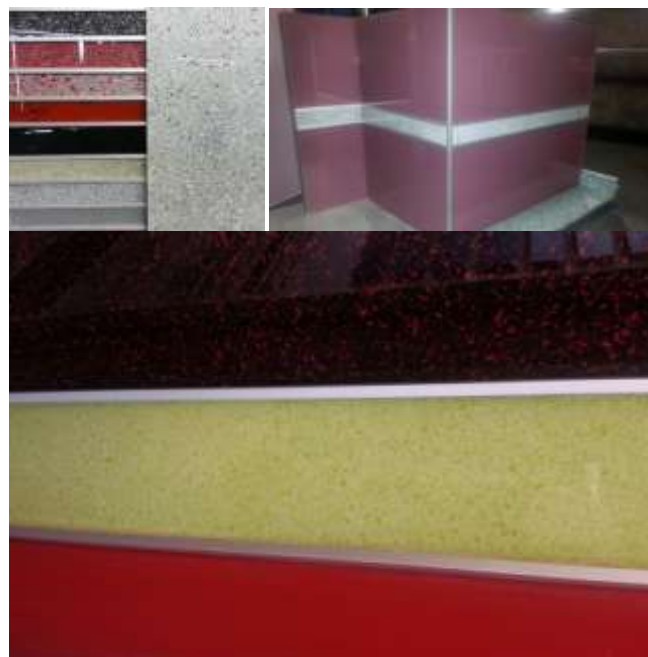

Bonethane™ Splashbacks



08 83818880

Customised Vetropoly™ Toughened Glass for behind your gas burner



Let ISPS assist you with your cook top needs. If you have a gas burner then Vetropoly™ Toughened Glass is just for you. ISPS can customise glass dimensions to reside specifically behind your cook top in metallic silver or colour toned to Bonethane sheeting.

STD Bonethane Premium PACK offer & Upgrades.....

PREMIUM SHEET PACKAGE DEAL enclosed in this pack are the following items

- ❖ 1 Sheet Bonethane® Premium 2440 x 760 x 5mm
 - ❖ 1 Flat colour match on any flat colour (additional charge on metallic, Abstract or digital Art)
 - ❖ 3 straight cuts (all the way through the sheet, angled cuts additional charge)
 - ❖ 1 fire rated insert in Silver in either 600 x 650mm or 900 x 650mm (additional charge on colour toning or customising insert)
 - ❖ 6 Anodised Trim @ 760mm
 - ❖ 1 Custom Filler EFX™ 65mm x 760mm
 - ❖ \$ 738.00 delivered
-
- ❖ 1 Sheet Bonethane® Premium 2700 x 760 x 5mm
 - ❖ 1 Flat colour match on any flat colour (additional charge on metallic, Abstract or digital Art)
 - ❖ 3 straight cuts (all the way through the sheet, angled cuts additional charge)
 - ❖ 1 fire rated insert in Silver in either 600 x 650mm or 900 x 650mm (additional charge on colour toning or customising insert)
 - ❖ 6 Anodised Trim @ 800mm
 - ❖ 1 Custom Filler EFX™ 65mm x 800mm
 - ❖ \$ 819 delivered

Standard costing on some of our Premium range.

Does not include EFX, Metallic or digitalArt.

SINGLE SHEETS (not a pack)

- 2440 x 1220 x 5mm Bonethane Premium Sheet in any solid colour \$ 519.00inc gst delivered **(SPECIAL)**
- 2440 x 760 x 5 mm Bonethane Premium Sheet in any solid colour \$ 446.00 inc gst delivered
- 2600 x 760 x 5 mm Bonethane Premium Sheet in any solid colour \$ 476.21 inc gst delivered
- 3000 x 760 x 5mm Bonethane Premium Sheet in any solid colour \$ 596.14 inc gst delivered

Bonethane Premium making you the **DIY Master!**™

Splashback – Blank, straight cut NAME: _____ CONTACT PHONE: _____

EMAIL ADDRESS _____ Purchase order number _____

Diagram

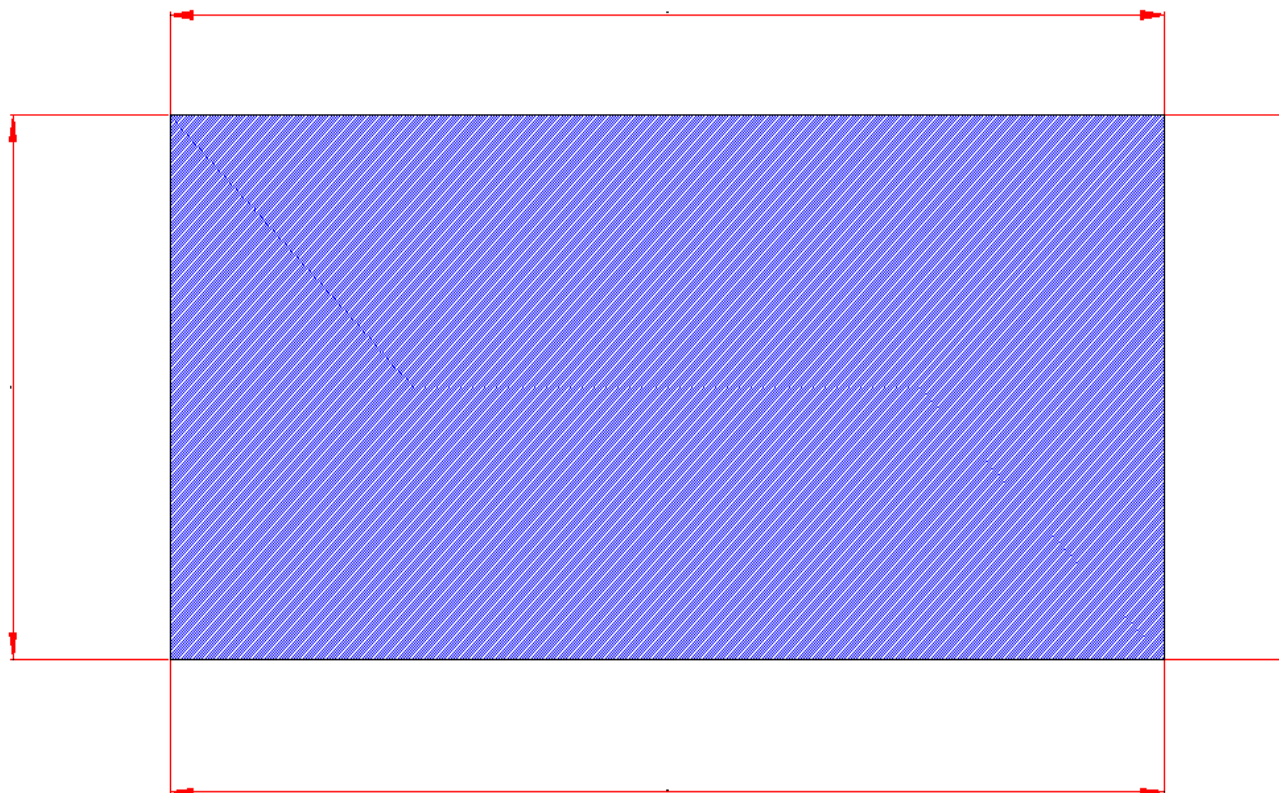
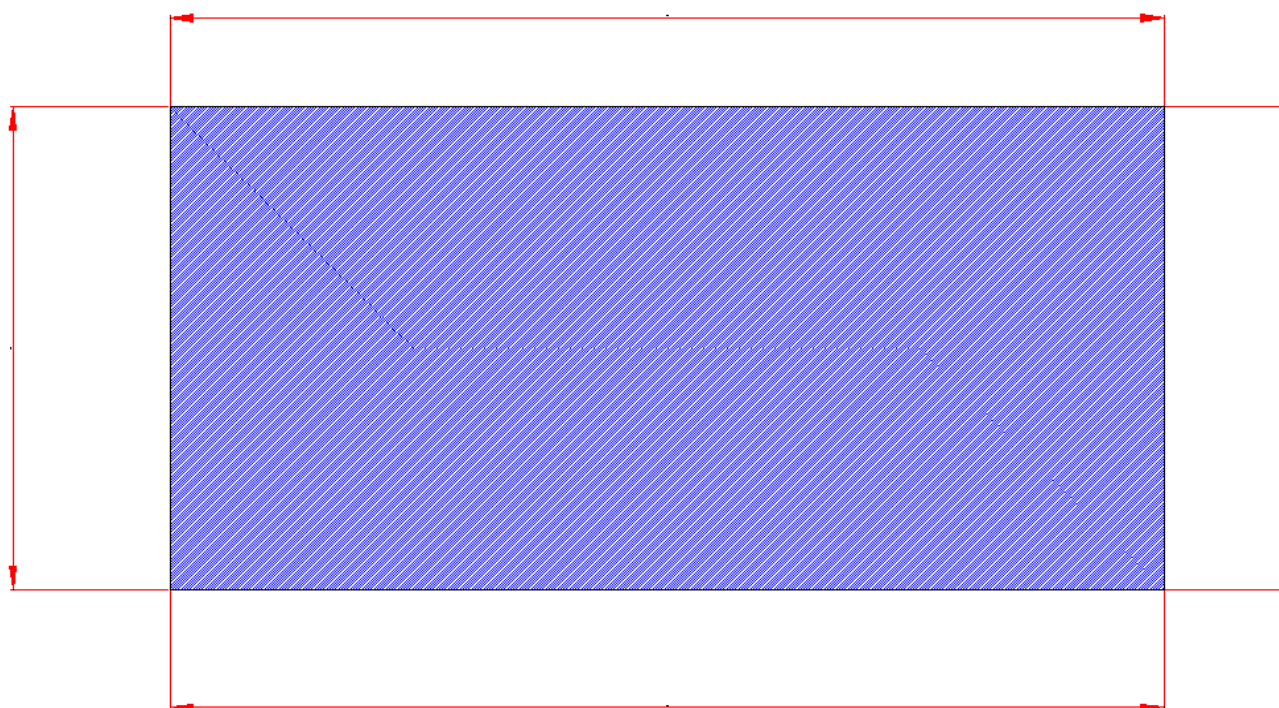

Diagram:



Splashback - Central Cut Out and PowerPoints NAME: _____ CONTACT PHONE: _____

EMAIL ADDRESS _____ Purchase order number _____

Diagram

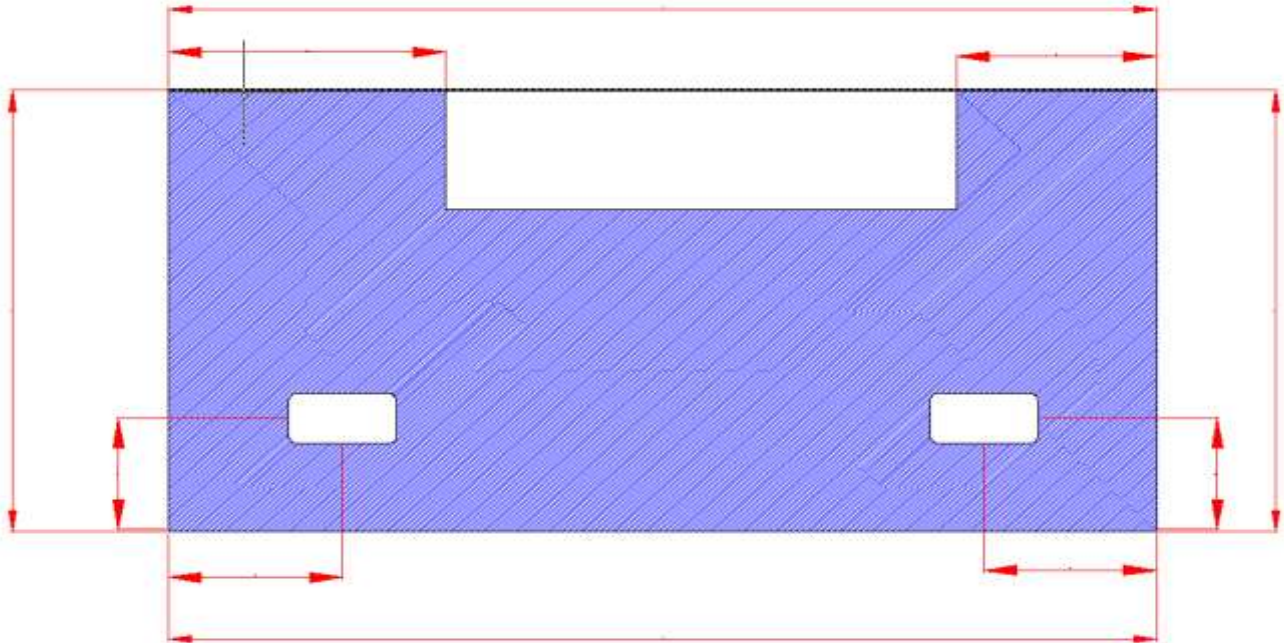

Diagram

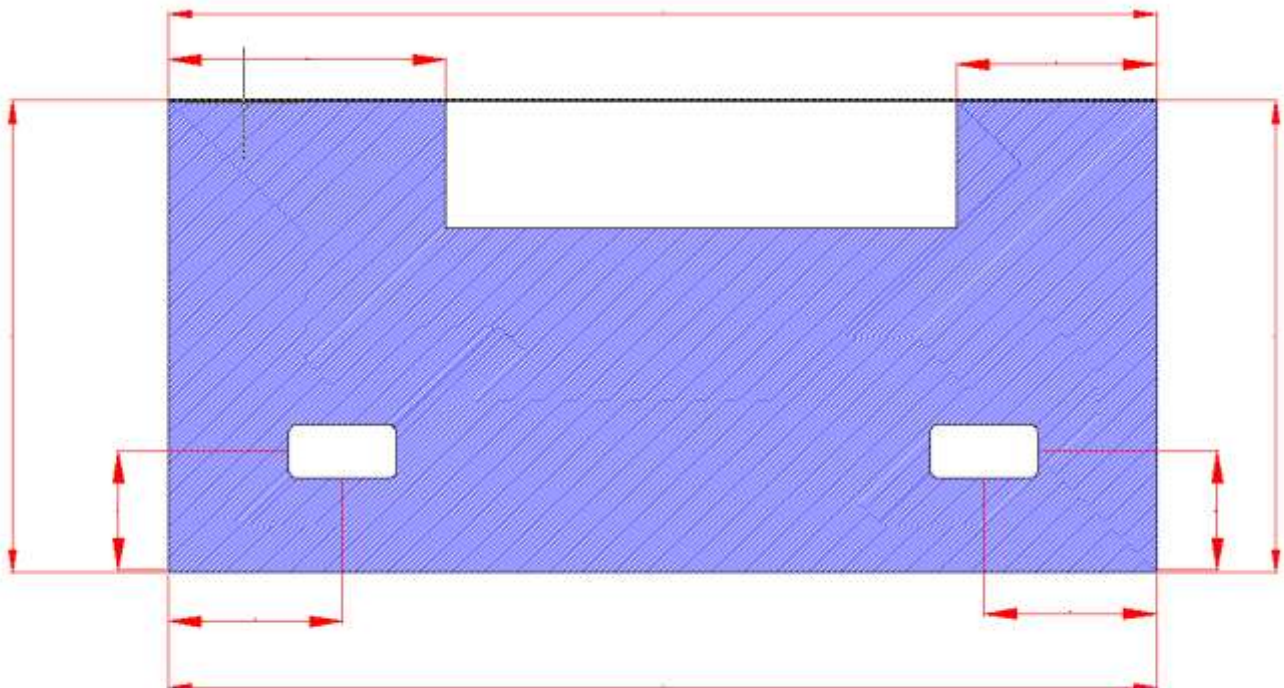

Splashback - Central Rangehood - 2 PowerPoints NAME: _____ CONTACT PHONE: _____

EMAIL ADDRESS _____ Purchase order number _____

Diagram

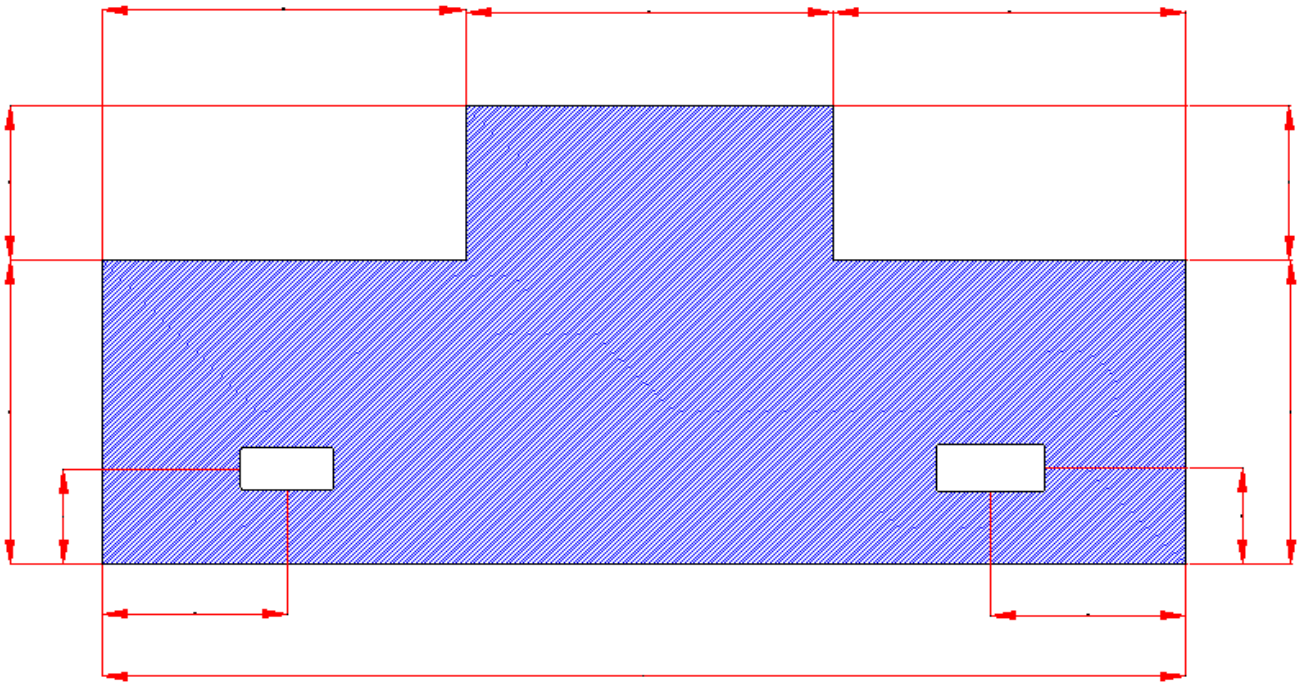

Diagram

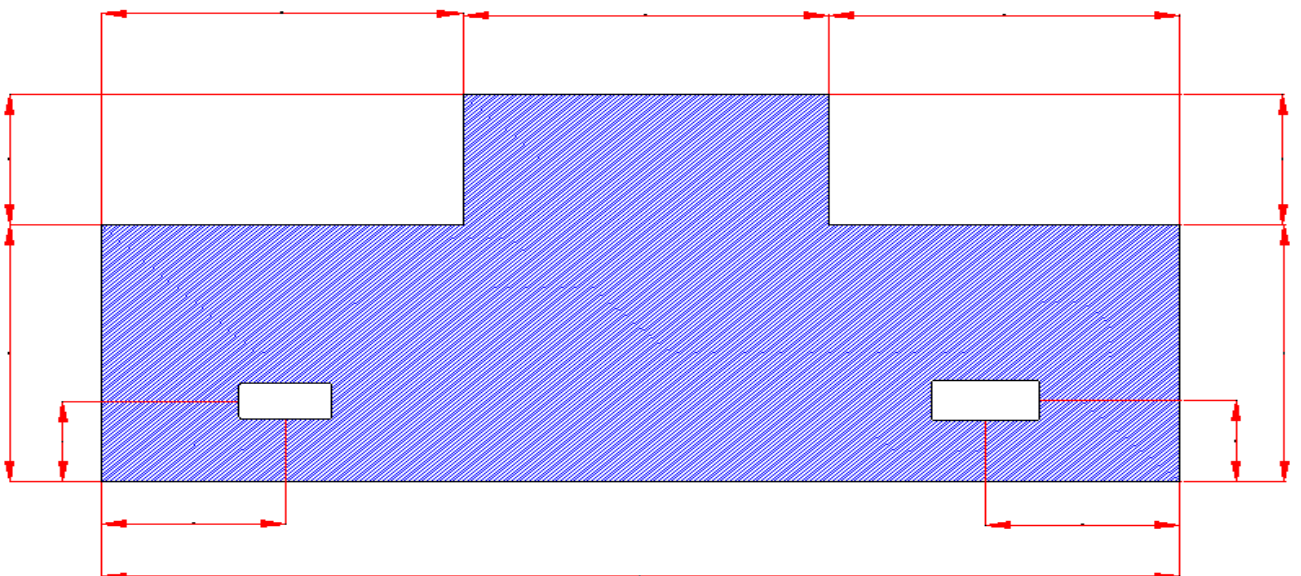

Splashback - Central Rangehood - Left Hand PowerPoin NAME: _____ CONTACT PHONE _____

EMAIL ADDRESS _____ Purchase order number _____

Diagram

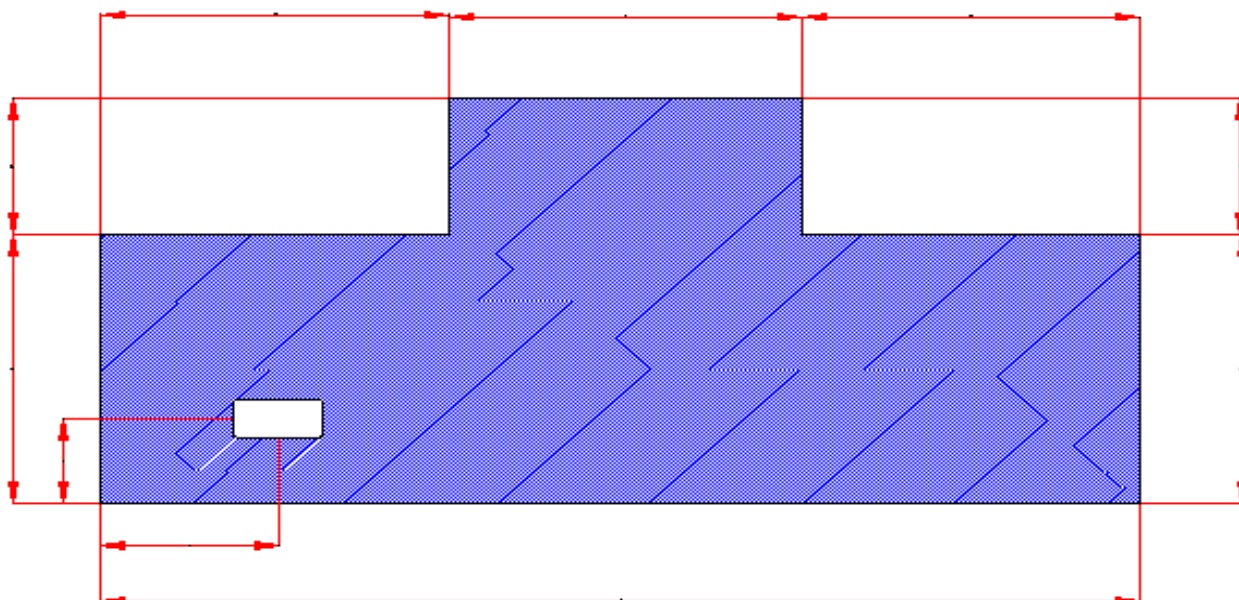

Diagram

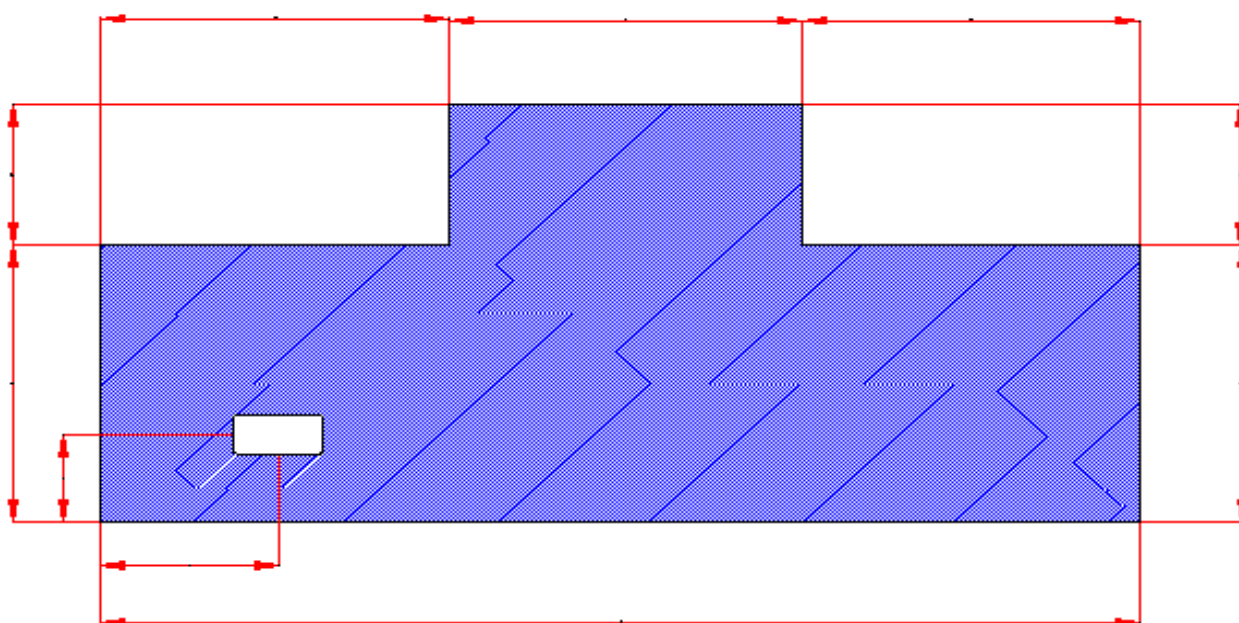

Splashback - Central Rangehood - Right Hand PowerPoint NAME: _____ CONTACT PHONE _____

PHONE: _____ EMAIL ADDRESS _____

Diagram

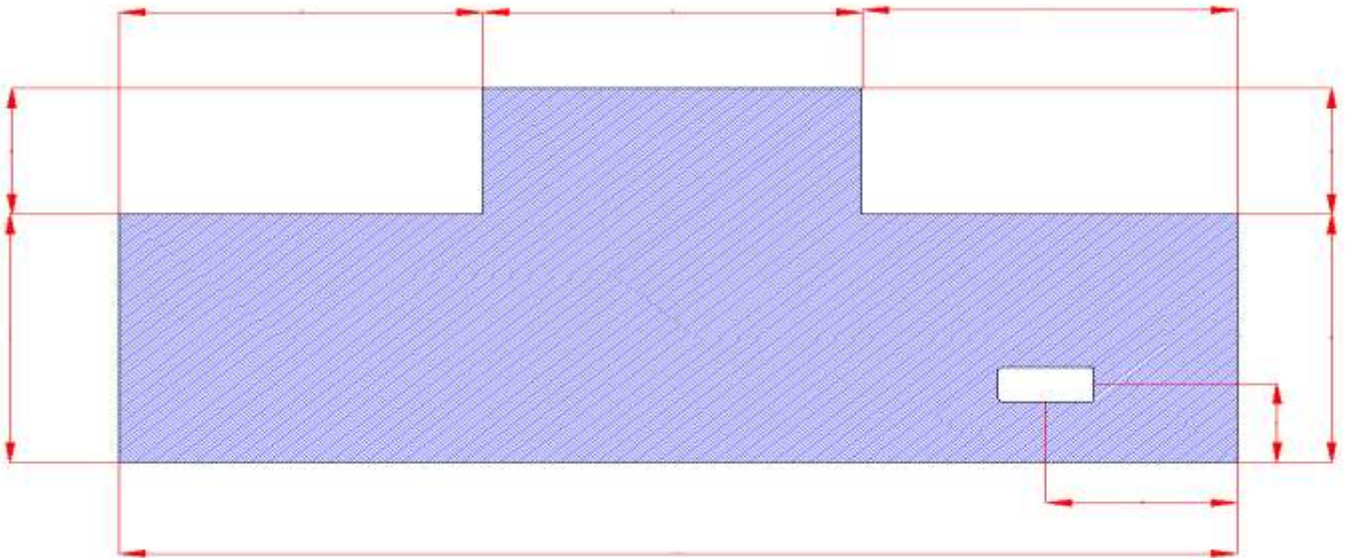

Diagram

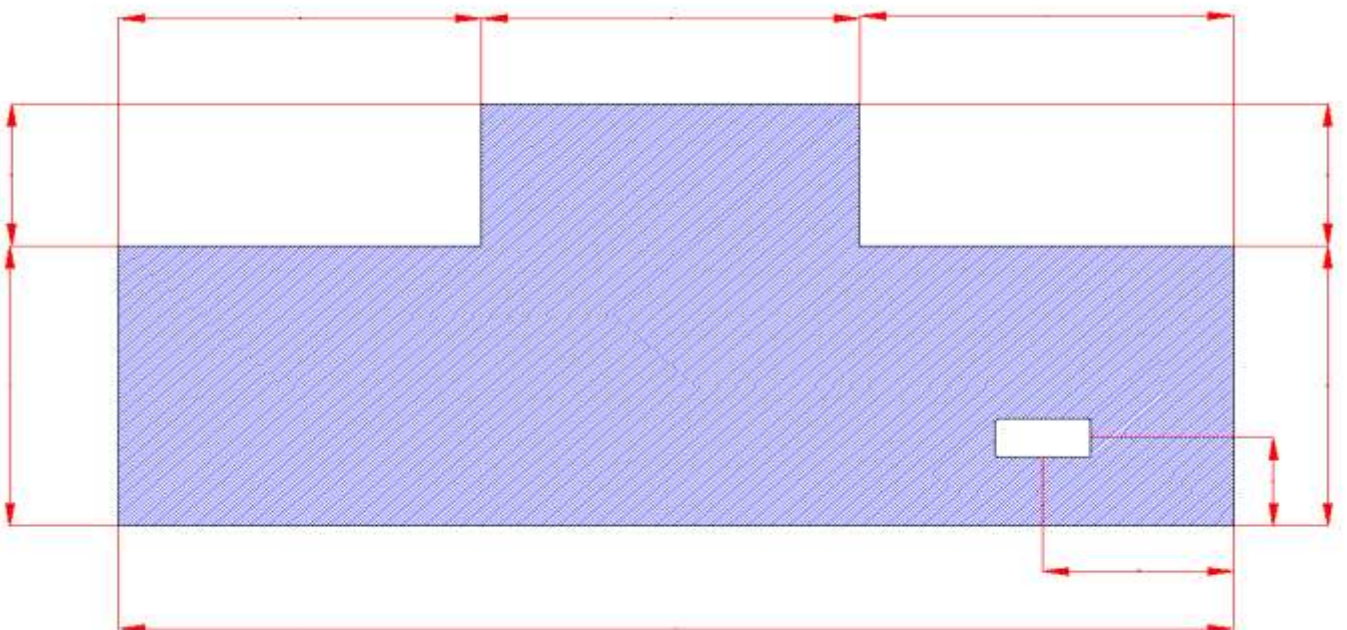

Splashback - Central Rangehood

NAME: _____ CONTACT PHONE _____

PHONE: _____ EMAIL ADDRESS _____

Diagram

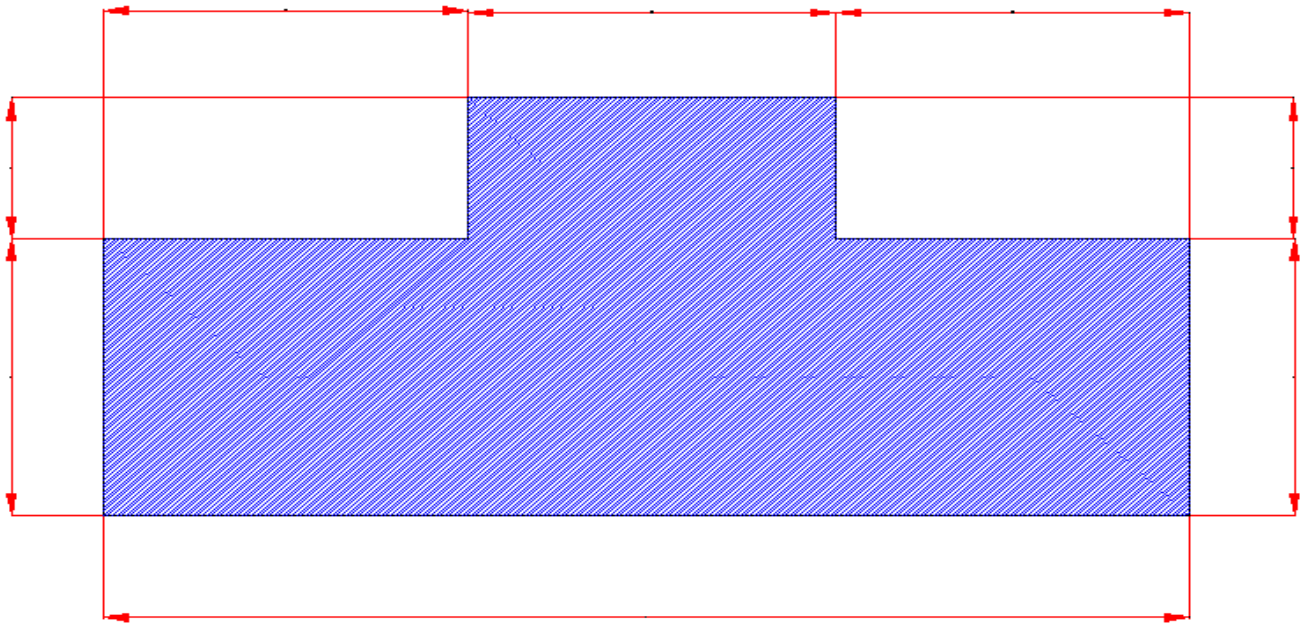

Diagram

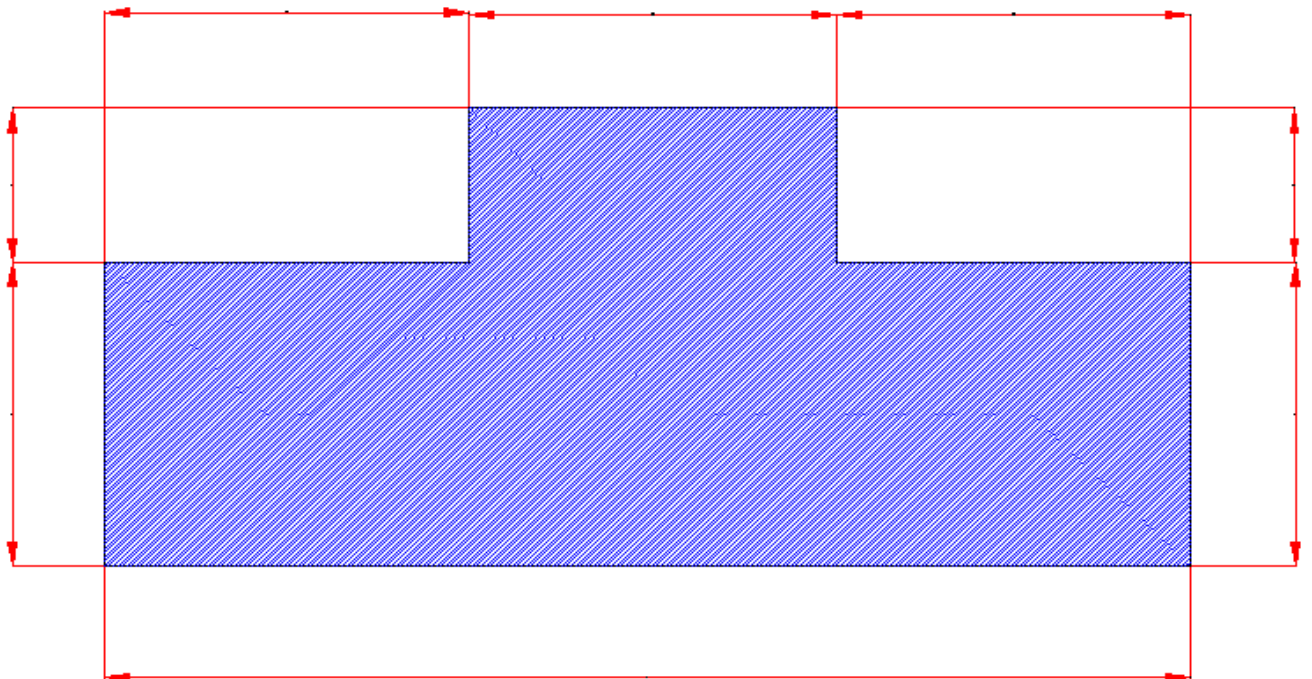



ISPS Innovations bring you DigitalArt Splashbacks™

- You can purchase from our esteemed photographer & create your digitalArt image master piece. Suitable for any home, shop display Bathroom & Shower areas the options are endless. Promote your Business, Bonethane is great for out doors!
- You may have your own image. Simply produce a high resolution format of 300 DPI or EPS file, ISPS will work with you to produce your Digital Art delivered to you.
- ISPS add GripTek™ to the back of the all our Bonethane sheets. eliminating the bleeding of silicone and shadows from walls and more.
- 14 to 21 work day turn around to NSW, SA, VIC, QLD. 21 to 28 Days in WA, NT, Nth QLD, TAS

Bonethane Premium Vs Acrylic candle burn test

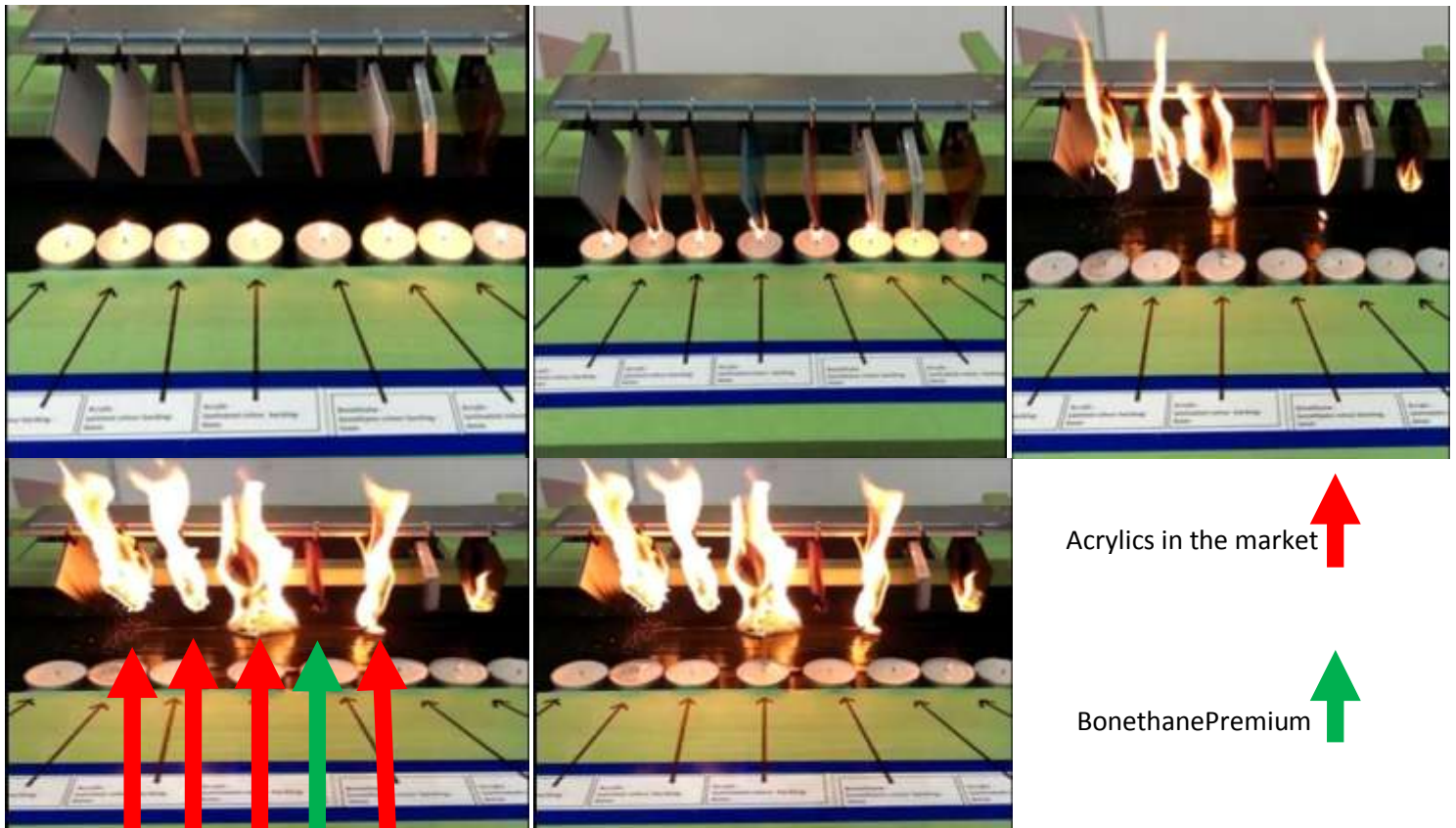

BonethanePremium® the right choice

A candle burn test is conducted in a controlled environment. Bonethane Premium is the green arrow. Within a minute the acrylic substrates indicated in red accelerate with fury, with the flames rising. Bonethane Premium® stands the test, while Acrylic falls to lava.

Let ISPS Innovations assist you with all your custom interior & exterior needs. No minimum order quantity.

Stay tuned, more updates to follow.

SPECIALISING IN

- **Benchtops in ColourTek™**
- **Partitions in ColourTek™**
- **Polyurethane Doors in Colour Tek™**
- **BonethanePremium® Splashbacks & Wall Panels**
- **BonethaneGN™ Acrylic grade Splashbacks & Wall Panels**
- **Bonethane10 Flooring, Benchtops, Wall Panels**
- **IPA Acrylic™ Splashbacks & Wall Panels**
- **Vetropoly™ Toughened StarFire Glass**
- **Alumethane™ composite panels**
- **KUTTM8™**



NEW YOU TUBE CLIP ON INSTALL OF BONETHANE PREMIUM LAUNCHED. ALSO SCRATCH TEST ON OUR PREMIUM SHEET. SEE US POLISH PREMIUM GRADE IN REAL TIME BEFORE YOUR EYES! <http://www.youtube.com/watch?v=SwpP8VSA3Yq>

www.ispsinnovations.com.au

BURN TEST Bonethane Premium Vs Acrylic & Candle Test, Bonethane Premium goes head to head with Acrylic substrates <http://www.youtube.com/watch?v=5LbYZRtsvtY> (Bonethane Premium Vs Acrylic)

http://www.youtube.com/watch?v=icI9VoH0_Vs

(Line up candle test, Bonethane premium is 5th in the line up (red sample) counting from left to right)

©

