



**Kilargo**

dormakaba Group

# INTUMESCENT FIRE & SMOKE SEALS

## KP1004, KP1504, KP2004, KP2504, KP3006



Fire & Smoke Seals

Incorporated into the perimeter of fire door assemblies. When exposed to fire conditions, these strip seals expand to many times their original volume, sealing off the door perimeter to prevent the passage of hot smoke & other toxic gases.

### Key Features

- Proven product with over 30 years in service history.
- Rebated into the door or frame for longevity in service.
- Decorative and protective PVC outer casing.
- Available in many sizes and finishes.
- Ideal for fire engineered solutions where extra protection is necessary for life safety.

### Use With

Can be used in conjunction with a Kilargo medium temperature smoke seal such as the IS1212, IS1515 or IS0511 seal to maintain tenable conditions across all temperatures of smoke (ambient, medium and hot) in a typical fully developed fire scenario.

### Materials

High performance sodium silicate based intumescent core encapsulated in a rigid flame retardant PVC outer casing, complete with aggressive self-adhesive tape backing.

### Gap Size

Minimum 1mm - Maximum 3mm

The product sits flush with the edge of the door leaf or door frame edge.

### Standard lengths

- 1000mm
- 2100mm
- 2400mm
- 2700mm
- 3000mm

### Standard colours

- Black
- Grey
- (White & dark brown colours available to special order).

### Fixing

The product fits into a groove made in the door frame or the edge of the door leaf and is secured using the self-adhesive tape backing.

### Approval/s

- Fully tested to AS1530 Part 4 for up to 2 hours on proprietary fire door assemblies in accordance with AS1905 Part 1.

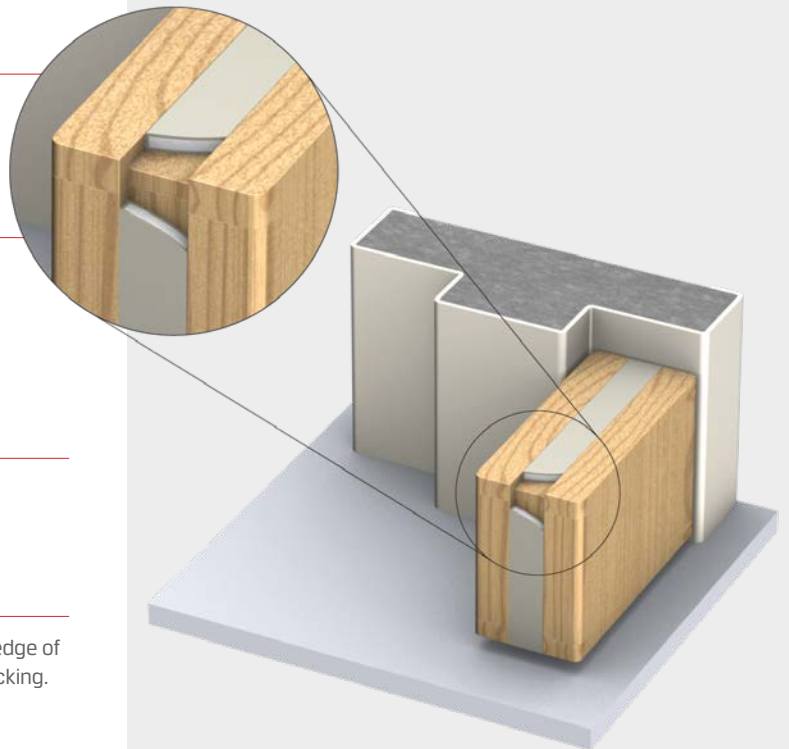
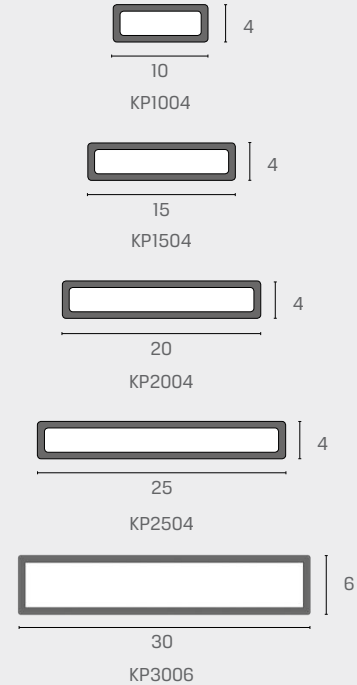

For more product information please scan QR code or visit [www.kilargo.com.au/ourproducts/kp1004/](http://www.kilargo.com.au/ourproducts/kp1004/)



All seals proudly manufactured in Australia

## KP1504TS, KP2004TS



High performance sodium silicate based intumescent fire and smoke seal. The intumescent core is encapsulated in a flame-retardant PVC outer casing with centrally located twin smoke and acoustic fins. Incorporated into the perimeter of fire door assemblies. When exposed to fire conditions, these intumescent strip seals expand to many times their original volume, sealing off the door perimeter to prevent the passage of hot smoke and other toxic gases.

### Key Features

- One seal only for fire and all temperatures of smoke.
- Rebated into the door or frame for longevity in service.
- Decorative and protective PVC outer casing.
- Ideal for fire engineered solutions where extra protection is necessary for life safety.

### Materials

High performance sodium silicate based intumescent core encapsulated in a rigid flame retardant PVC outer casing with coextruded twin sealing fins. Supplied with aggressive self adhesive backing.

### Gap Size

Minimum 2mm - Maximum 3mm

The product sits flush with the edge of the door leaf or door frame edge.

### Standard lengths

- 1000mm
- 2100mm
- 2400mm
- 2700mm
- 3000mm

### Standard fin height

4mm

### Standard colours

- Black
- Grey

### Fixing

The product is fitted into a groove in the door frame or the edge of the door leaf and is fixed using the self-adhesive tape backing.

### Approval/s

- Fully tested to AS1530 Part 4 for up to 2 hours on proprietary fire door assemblies in accordance with AS1905 Part 1
- Medium temperature smoke leakage approvals to AS1530 Part 7, compliant with AS6905 on proprietary door assemblies
- Conforms with BCA Specification C3.4 smoke sealing requirements
- Acoustically tested in accordance with AS1191, ISO140.3 & ISO10140-2
- Independent tests have been conducted demonstrating over 100,000 open and close cycles without significant wear.

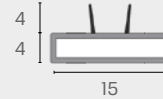

KP1504TS



KP2004TS

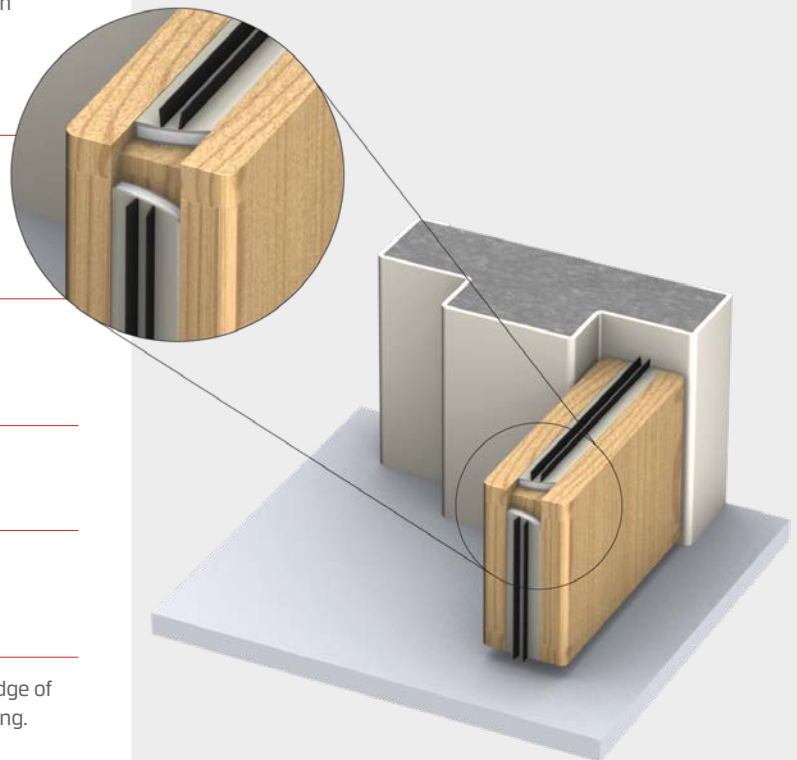

For more product information please scan QR code or visit [www.kilargo.com.au/ourproducts/kp1504ts/](http://www.kilargo.com.au/ourproducts/kp1504ts/)



All seals proudly manufactured in Australia

## KP3107, KP3107SS



Incorporated into proprietary fire door and life safety door assemblies to provide resistance against fully developed fires where hot flames, gases and smoke are at extreme temperatures.

### Key Features

- Utilised in proprietary aluminium bullnose meeting stile sections.
- Decorative and protective PVC outer casing. 'SS' version has offset brush pile incorporated into profile to help provide resistance to smoke.
- Ideal for fire engineering solutions where fire (or fire & smoke) protection is necessary.

### Use With

Used in conjunction with other Kilargo intumescent perimeter seals and door bottom seals, as tested on typical proprietary fire doors.

### Materials

- **KP3107:** High performance sodium silicate based intumescent core encapsulated in a rigid flame retardant PVC outer casing, complete with aggressive self-adhesive tape backing.
- **KP3107SS:** KP3107 intumescent seal with incorporated, offset brush pile.

### Gap Size

Minimum 1mm - Maximum 3mm  
(Dependent on seal type and application)

- **KP3107:** This product sits flush with the edge of the door leaf or door frame edge.
- **KP3107SS:** This product is usually incorporated into proprietary fire door meeting stile sections.

### Standard lengths

- 2100mm
- 2400mm
- 3000mm

### Finish

- KP3107: Grey
- KP3107SS: Grey with black brush pile

### Fixing

- **KP3107:** The product fits into a groove made in the edge of the door leaf, or door frame and is secured using the self-adhesive tape backing.
- **KP3107SS:** This product can be fitted into the proprietary aluminium sections of bullnose meeting stiles for double action fire doors.

### Approval/s

- Fully tested to AS1530 Part 4 for up to 2 hours on proprietary fire door assemblies in accordance with AS1905 Part 1.

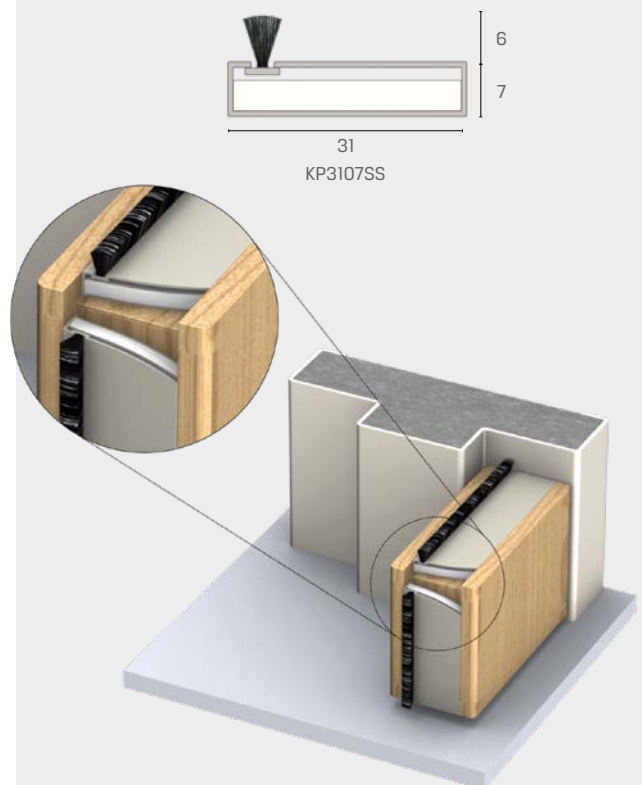
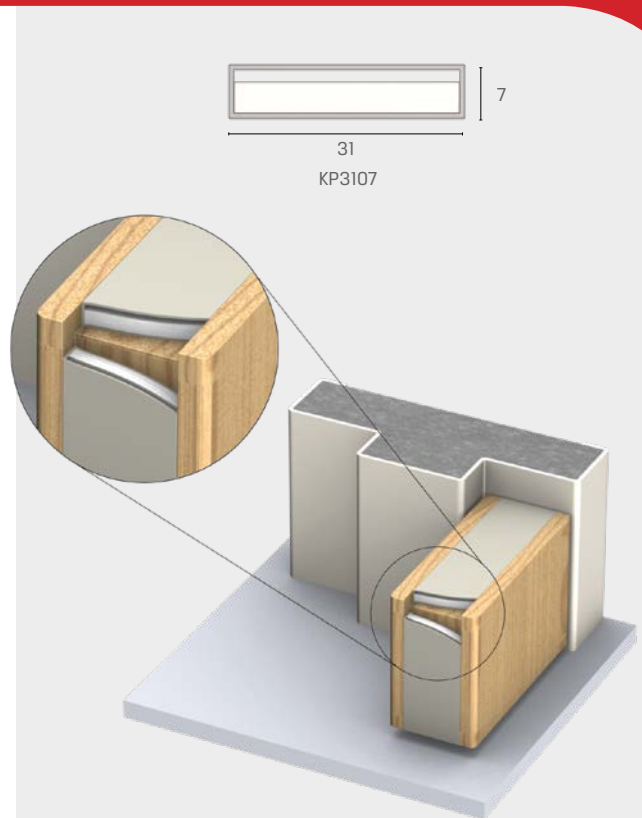

For more product information please scan QR code or visit [www.kilargo.com.au/ourproducts/kp3107/](http://www.kilargo.com.au/ourproducts/kp3107/)



All seals proudly manufactured in Australia

## KP3504TF



Incorporated into fire, smoke and life safety door assemblies to provide resistance against all stages of fire and smoke whilst also providing excellent acoustic properties.

### Key Features

- Dual offset fin seals (TF) provides outstanding smoke and sound containment properties.
- Provides an ideal alternative for double swing pivot door assemblies, where the smoke seal can remain uninterrupted while the seal body is checked to allow for any door hardware.
- Simple self-adhesive / screw-fix application onto the bottom of the door.

### Use With

Used in conjunction with a Kilargo 4000 Series threshold plate to provide a total door bottom sealing solution.

### Materials

High performance intumescent core with a rigid PVC casing combined with dual elastomeric smoke and acoustic fins. Supplied with aggressive self adhesive backing.

### Gap Size

10mm (dependent upon installation)

### Standard lengths

820mm, 920mm, 1220mm  
Other lengths to special order

### Standard fin height

9mm

### Standard colour

- Black

### Fixing

The product is fitted to the underside of the door leaf using the aggressive self-adhesive backing tape and simple screw-fixing.

### Approval/s

- Fully tested to AS1530 Part 4 for up to 2 hours on proprietary fire door assemblies in accordance with AS1905 Part 1
- Medium temperature smoke leakage approvals to AS1530 Part 7, compliant with AS6905 on proprietary door assemblies
- Conforms with BCA Specification C3.4 smoke sealing requirements
- Acoustically tested in accordance with AS1191, ISO140.3 & ISO10140-2.

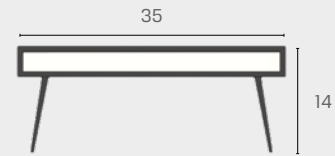

KP3504TF

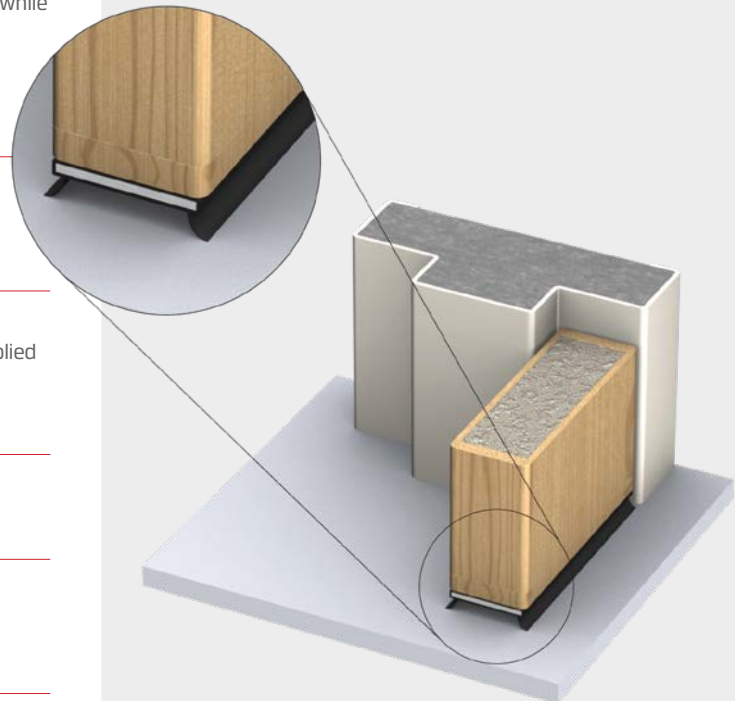

For more product information please scan QR code or visit [www.kilargo.com.au/ourproducts/kp3504tf/](http://www.kilargo.com.au/ourproducts/kp3504tf/)



All seals proudly manufactured in Australia

## KP4204TF



Fire & Smoke Seals

Incorporated into fire, smoke and life safety door assemblies to provide resistance against all stages of fire and smoke whilst also providing excellent acoustic properties.

### Key Features

- Dual offset fin seals (TF) provides outstanding smoke and sound containment properties.
- Provides an ideal alternative for double swing pivot door assemblies, where the smoke seal can remain uninterrupted while the seal body is checked to allow for any door hardware.
- Tested on proprietary fire doors providing up to 2 hours fire resistance.
- Simple self-adhesive / screw-fix application onto the bottom of the door.

### Use With

Used in conjunction with a Kilargo 4000 Series threshold plate to provide a total door bottom sealing solution.

### Materials

High performance intumescent core with a rigid PVC casing combined with dual elastomeric smoke and acoustic fins. Supplied with aggressive self adhesive backing.

### Gap Size

10mm (dependent upon installation)

### Standard lengths

820mm, 920mm, 1220mm  
Other lengths to special order.

### Standard fin height

9mm

### Standard colour

- Black

### Fixing

The product is fitted to the underside of the door leaf using the aggressive self-adhesive backing tape and simple screw-fixing.

### Approval/s

- Fully tested to AS1530 Part 4 for up to 2 hours on proprietary fire door assemblies in accordance with AS1905 Part 1
- Medium temperature smoke leakage approvals to AS1530 Part 7, compliant with AS6905 on proprietary door assemblies
- Conforms with BCA Specification C3.4 smoke sealing requirements
- Acoustically tested in accordance with AS1191, ISO140.3 & ISO10140-2

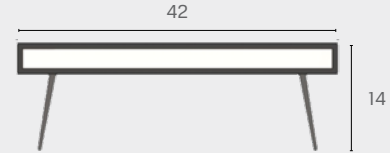

KP4204TF

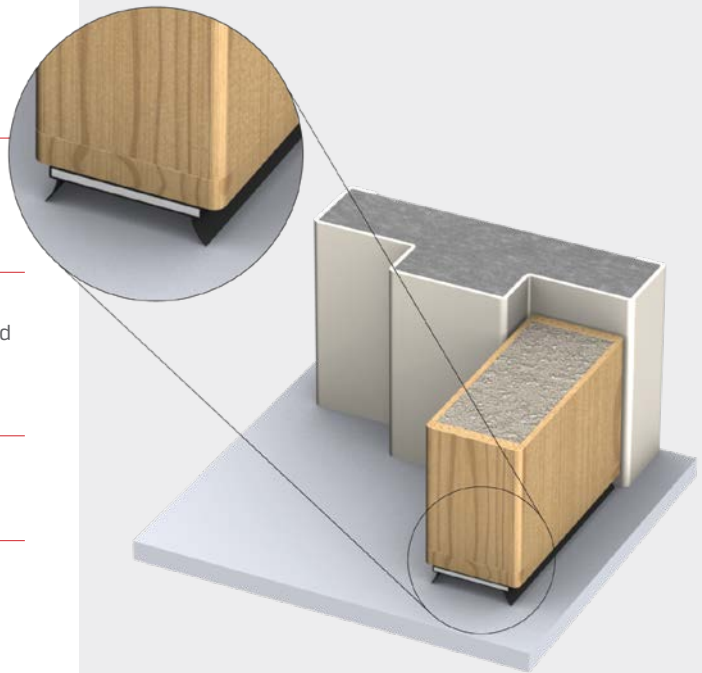

For more product information please scan QR code or visit [www.kilargo.com.au/ourproducts/kp4204tf/](http://www.kilargo.com.au/ourproducts/kp4204tf/)



All seals proudly manufactured in Australia

## KG1202 & KG1602



Applied to the perimeter of fire door assemblies. When exposed to fire conditions, these strip seals expand to many times their original volume, sealing off the door perimeter to prevent the passage of hot smoke and other toxic gases.

### Key Features

- Easy retrofit installation.
- Simple self-adhesive application onto the door frame.
- Flexible seal is supplied in coils to minimize wastage when cutting lengths to size.
- Ideal for fire engineered solutions where extra fire protection is required.

### Use With

Used in conjunction with a Kilargo door bottom solution, such as the IS8010si automatic door bottom seal or KP4204TF intumescent sweep type seal to provide a total door sealing solution.

### Materials

Kilargo high performance, graphite based, intumescent core, supplied with aggressive self-adhesive backing tape.

### Gap Size

Nominal 3mm perimeter gaps.

### Dimensions

- KG1202: 12mm x 2mm
- KG1602: 16mm x 2mm

### Standard lengths

- 50 metre coils

### Standard colour

- Black

### Fixing

This product can be simply retrofitted to a steel frame, or set into a mortised groove in the door frame or the edge of the door leaf, using the aggressive self-adhesive backing tape.

### Approval/s

- Fully tested to AS1530 Part 4 for up to 2 hours on proprietary fire door assemblies in accordance with AS1905 Part 1.

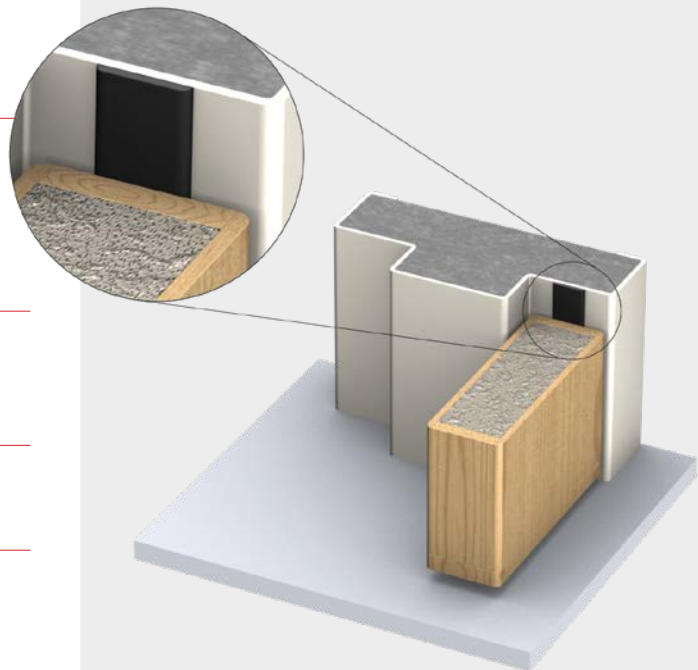

For more product information please scan QR code or visit [www.kilargo.com.au/ourproducts/kg1202/](http://www.kilargo.com.au/ourproducts/kg1202/)



All seals proudly manufactured in Australia

## KG1602AS



Applied to the perimeter of fire door assemblies. When exposed to fire conditions, these strip seals expand to many times their original volume, sealing off the door perimeter to prevent the passage of hot smoke and other toxic gases. These seals also incorporate an offset fin to provide smoke control across all temperatures.

### Key Features

- Offset fin seal (AS) provides outstanding smoke and sound containment properties.
- One seal only for fire and all temperatures of smoke.
- Simple self-adhesive application onto the door or frame.
- Flexible seal is supplied in coils to minimize wastage when cutting lengths to size.
- Ideal for fire engineering solutions where extra protection is required.

### Use With

Used in conjunction with a Kilargo door bottom solution such as the IS8010si automatic door bottom or KP4204TF intumescent sweep type seal to provide a total door sealing system.

### Materials

Kilargo high performance graphite based intumescent core with a co-extruded, asymmetric smoke and acoustic fin. Supplied with aggressive self adhesive backing.

### Gap Size

Nominal 3mm

### Standard lengths

50 metre coils

### Standard colour

Black

### Fixing

The product can be simply retro-fitted to a steel frame, or set into a morticed groove in the door frame or the edge of the door leaf, using the aggressive self-adhesive backing tape.

### Approval/s

- Fully tested to AS1530 Part 4 for up to 2 hours on proprietary fire door assemblies in accordance with AS1905 Part 1

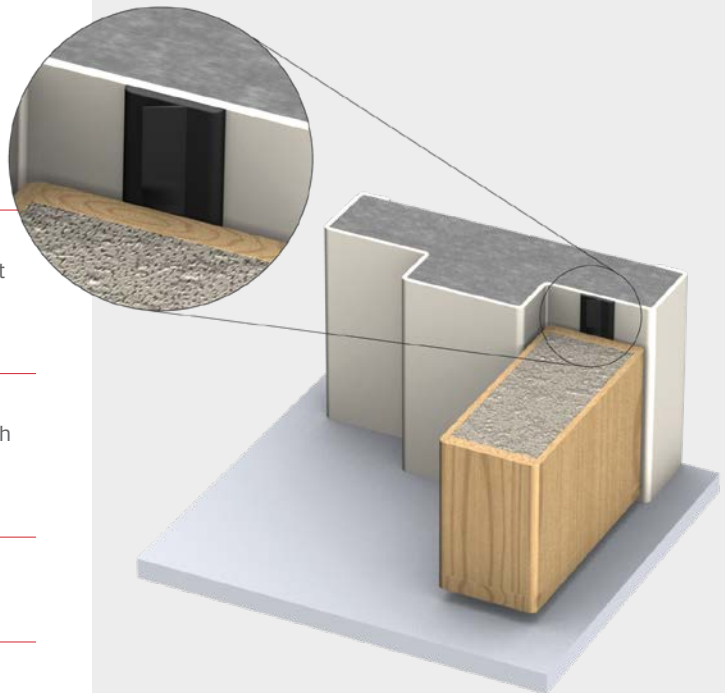

For more product information please scan QR code or visit [www.kilargo.com.au/ourproducts/kg1602as/](http://www.kilargo.com.au/ourproducts/kg1602as/)



All seals proudly manufactured in Australia



## KG1612BW



This hybrid, intumescent fire & smoke seal is simply fitted onto the rebate of a door frame perimeter to provide resistance against fire, smoke, sound, draughts, dust and light.

### Key Features

- Tested on proprietary fire doors for up to 2 hours fire resistance.
- Fits quickly and easily without removal of the door.
- Provides an excellent acoustic & smoke seal across all temperatures.
- Offers an outstanding acoustic performance.
- Simple self-adhesive application onto the door frame.
- Strategically located in the impact free zone of the opening.

### Use With

Used in conjunction with a Kilargo door bottom solution such as the IS8010si automatic door bottom or KP3504TF seal to provide a total door sealing system.

### Materials

Kilargo high performance graphite based intumescent core with PVC skin combined with an elastomeric sealing blade. Supplied with aggressive self adhesive backing tape on both flanges of the carrier.

### Gap Size

Minimum 2mm - Maximum 3mm

### Sizes

Door Sets:	Single	1 x 1000mm, 2 x 2100mm
	Long Single	1 x 1000mm, 2 x 2750mm
	Double	3 x 2100mm
	Long Double	1 x 2100mm, 2 x 2750mm

### Standard lengths

1000mm, 2100mm, 2400mm, 2700mm, 3000mm

### Standard colours

- Black
- White

### Fixing

The product is fitted along the rebate of the door frame perimeter and applied using the integral self-adhesive backing tape.

### Approvals

- Fully tested to AS1530 Part 4 for up to 2 hours on proprietary fire door assemblies in accordance with AS1905 Part 1
- Acoustically tested in accordance with AS1191, ISO140.3 & ISO10140-2.
- Medium temperature smoke leakage approvals to AS1530 Part 7 available on proprietary door assemblies

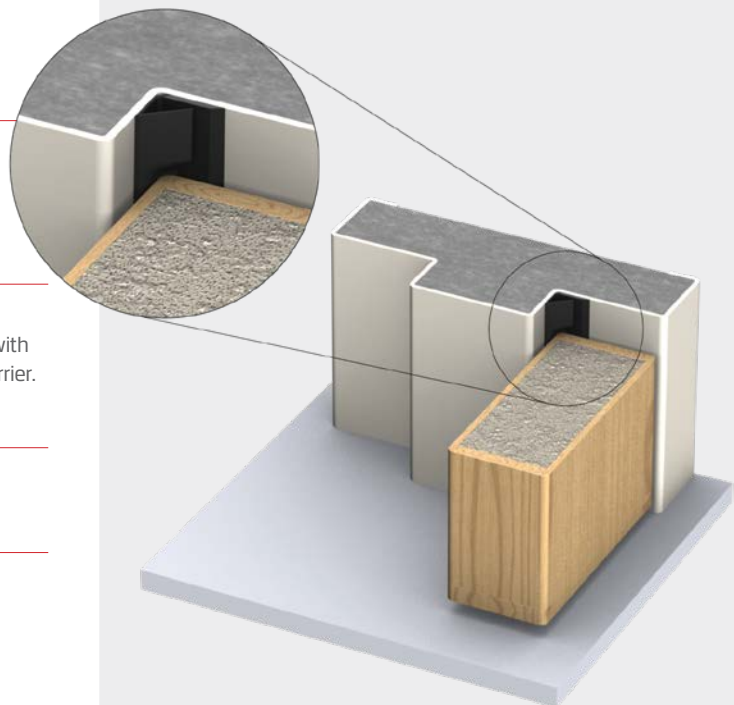

For more product information please scan QR code or visit [www.kilargo.com.au/ourproducts/kg1612bw/](http://www.kilargo.com.au/ourproducts/kg1612bw/)



All seals proudly manufactured in Australia

## KG2512BW



This hybrid, intumescent fire & smoke seal is simply fitted onto the rebate of a door frame perimeter to provide resistance against fire, smoke, sound, draughts, dust and light.

### Key Features

- Tested on proprietary fire doors for up to 2 hours fire resistance.
- Fits quickly and easily without removal of the door.
- An excellent 'life safety' seal, providing an ideal fire engineered solution, limiting the spread of fire and smoke across all temperatures.
- With dual elastomeric fins, this seal also offers outstanding acoustic performance.
- Simple self-adhesive application onto the door frame.
- Strategically located in the impact free zone of the opening.

### Use With

Used in conjunction with a Kilargo automatic door bottom seal for a complete life-safety sealing solution.

### Materials

Kilargo high performance graphite based intumescent core with PVC skin combined with dual elastomeric sealing blades. Supplied with aggressive self adhesive backing tape on both flanges of the carrier.

### Gap Size

Minimum 3mm- Maximum 5mm

### Sizes

Door Sets: Single	1 x 1000mm, 2 x 2100mm
Long Single	1 x 1000mm, 2 x 2750mm
Double	3 x 2100mm
Long Double	1 x 2100mm, 2 x 2750mm

### Standard lengths

1000mm, 2100mm, 2400mm, 2700mm, 3000mm

### Standard colour

- Black

### Fixing

The product is fitted along the rebate of the door frame perimeter and applied using the integral self-adhesive backing tape.

### Approval/s

- Fully tested to AS1530 Part 4 for up to 2 hours on proprietary fire door assemblies in accordance with AS1905 Part 1
- Medium temperature smoke leakage approvals to AS1530 Part 7 available on proprietary door assemblies
- Acoustically tested in accordance with AS1191, ISO140.3 & ISO10140-2

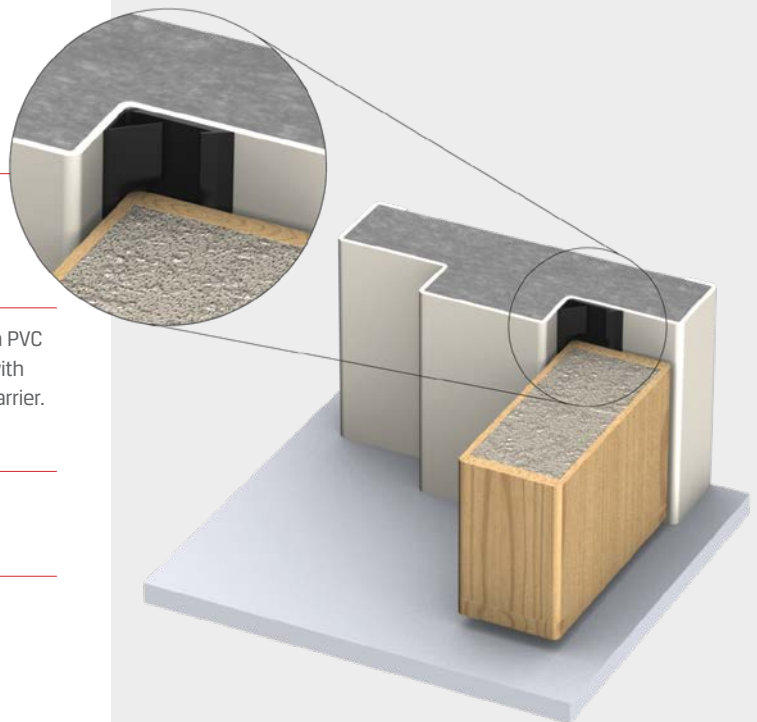
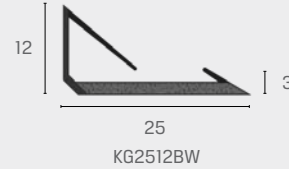

For more product information please scan QR code or visit [www.kilargo.com.au/ourproducts/kg2512bw/](http://www.kilargo.com.au/ourproducts/kg2512bw/)



All seals proudly manufactured in Australia

## FDMS-TP



Aluminium meeting stile seal set for proprietary single action fire door assemblies. Designed specifically for high performance smoke and sound containment for pairs of nom. 47mm fire doors.

### Key Features

- New modern and aesthetic appearance.
- Incorporates intumescent fire and smoke sealing technology.
- Improves acoustic performance.
- Can be used to upgrade existing fire doors.
- Easy installation.
- Sold as complete assembly, including a T-Bar and plain aluminium section with intumescent strips and flexible silicone smoke seal.

### Materials

Anodised aluminium astragals with integral high performance intumescent fire seals plus flame retardant silicone smoke and acoustic seal fitted to 'T' section.

### Gap Size

Minimum 2.5mm – Maximum 5mm

### Standard lengths

2135mm, 2440mm, 3050mm, 3500mm

### Finish

Clear anodised finish with grey silicone seal insert.

### Fixing

The Kilargo FDMS-T astragals come complete with the intumescent and silicone seal fitted. Simply cut to length and screw-fix to the respective door leaves.

### Approval/s

- AS1530/4 fire tests with proprietary fire door assemblies.
- Medium temperature smoke leakage approvals to AS1530 Part 7 available on proprietary door assemblies
- Conforms with BCA Specification C3.4 smoke sealing requirements
- Acoustically tested in accordance with AS1191, ISO140.3 & ISO10140-2.

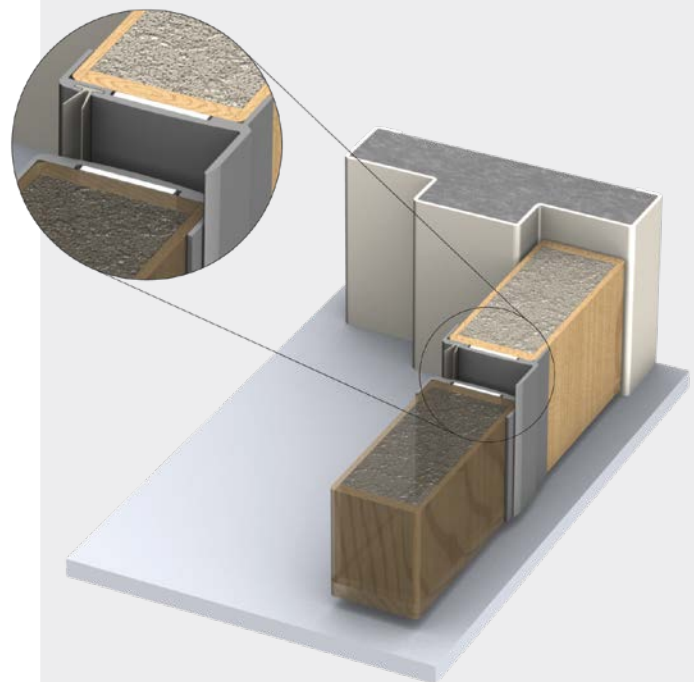
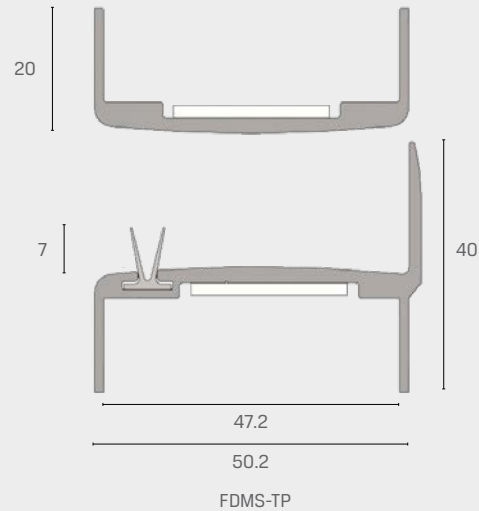

For more product information please scan QR code or visit [www.kilargo.com.au/ourproducts/fdms-tp/](http://www.kilargo.com.au/ourproducts/fdms-tp/)



All seals proudly manufactured in Australia

## FDMS-BB



Aluminium meeting stile seal set for proprietary double action fire door assemblies. Designed specifically for high performance smoke and sound containment for pairs of nom. 47mm fire doors.

### Key Features

- New modern and aesthetic appearance.
- Incorporates intumescent fire and smoke sealing technology.
- Improves acoustic performance.
- Can be used to upgrade existing fire doors.
- Easy installation.
- Sold as complete assembly incorporating 2 identical aluminium sections and PVC encased intumescent seals with elastomeric smoke and acoustic fins.

### Materials

Anodised aluminium astragals with integral high performance intumescent fire seals encapsulated in a rigid flame retardant PVC outer casing with a co-extruded single asymmetric smoke and acoustic fin.

### Gap Size

Minimum 2.5mm - Maximum 5mm

### Standard lengths

2135mm, 2440mm, 3050mm, 3500mm

### Finish

Clear anodised finish with silver colour fire seal and black offset fin.

### Fixing

The Kilargo FDMS-B bullnose stiles come complete with the aluminium sections and intumescent fire and smoke seals. Simply cut to length, screw aluminium sections onto the respective door leaves and insert the intumescent seals using aggressive self adhesive backing tape.

### Approval/s

- Fully tested to AS1530 Part 4 for up to 2 hours on proprietary fire door assemblies in accordance with AS1905 Part 1
- Conforms with BCA Specification C3.4 smoke sealing requirements
- Acoustically tested in accordance with AS1191, ISO140.3 & ISO10140-2.

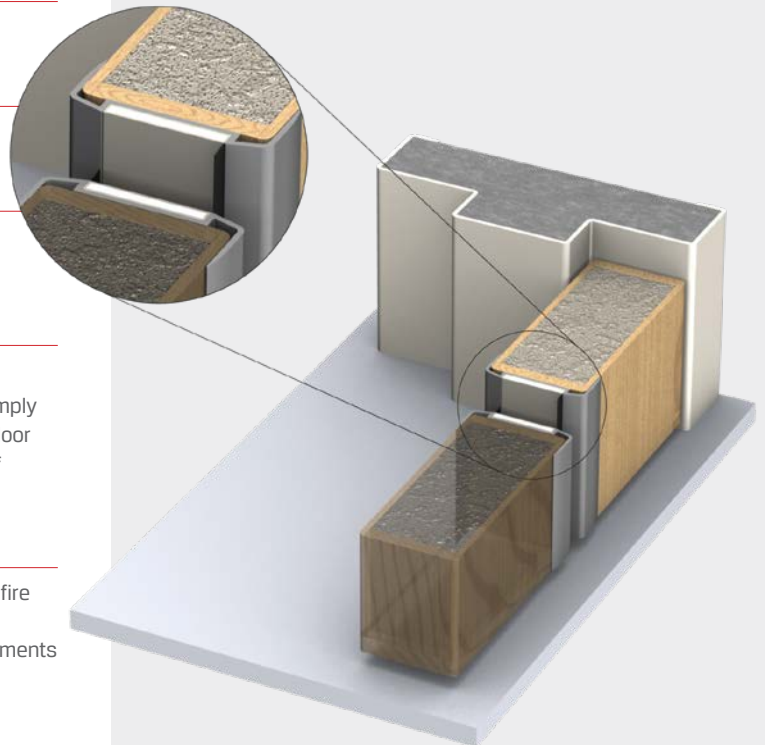
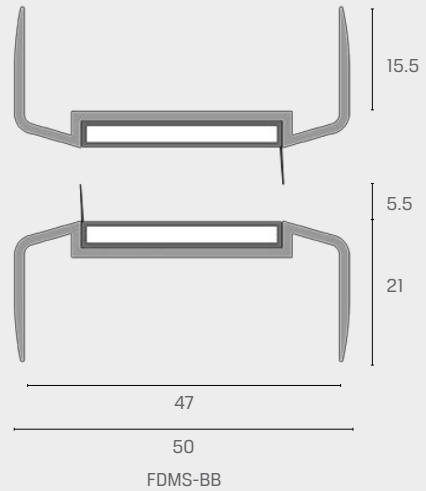

For more product information please scan QR code or visit [www.kilargo.com.au/ourproducts/fdms-bb/](http://www.kilargo.com.au/ourproducts/fdms-bb/)



All seals proudly manufactured in Australia

# Retrofit Intumescent Fire Door Bottom Upgrade Seals

## FDBU20



Used to upgrade existing fire doors where door bottom gaps exceed the allowable 10mm as per AS1905/1.

### Key Features

- Can provide up to 2 hours fire resistance when fitted to the bottom of proprietary fire doors.
- Non compliant fire doors can be salvaged.
- Avoids expensive door build-ups or door replacements.
- Cost-effective solution.
- Easy retro-fit installation.
- No need to remove the door during installation.

### Use With

Although not required for upgrade work, the Kilargo 4000 Series Threshold Plates may be incorporated as part of the overall system for both aesthetic and disability compliance issues.

### Materials

These products consist of an anodised aluminium profile, flame retardant smoke, draught and light excluding silicone gasket and integral high performance intumescent fire seals.

### Gap Size

To seal gap sizes up to 20mm maximum, under nom. 35mm and 45mm proprietary doors.

### Standard lengths

820mm, 920mm, 1220mm

### Standard colours

Clear Anodised (Silver) with grey gaskets

### Fixing

The FDBU20 is supplied with pre-drilled slotted holes and screws for easy application onto the bottom of door leaves.

### Approval/s

- Fully tested to AS1530 Part 4 for up to 2 hours on proprietary fire door assemblies in accordance with AS1905 Part 1
- Conforms with BCA Specification C3.4 smoke sealing requirements

NB: Check with your door manufacturer for approvals.

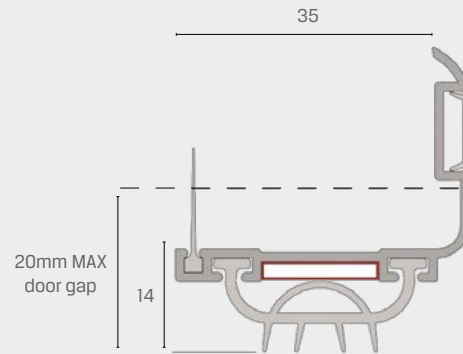

FDBU20

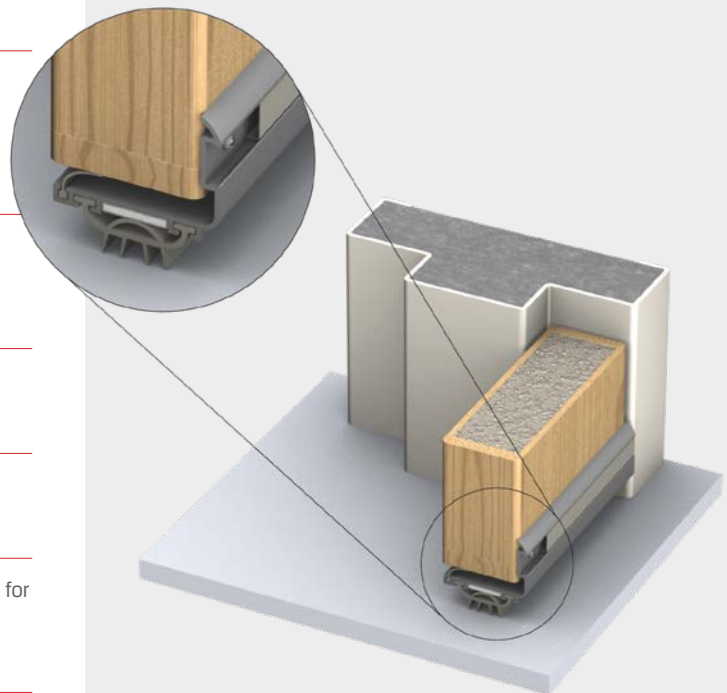

For more product information please scan QR code or visit [www.kilargo.com.au/ourproducts/fdbu20/](http://www.kilargo.com.au/ourproducts/fdbu20/)



All seals proudly manufactured in Australia

## FDBU60



Used to upgrade existing fire doors where door bottom gaps exceed the allowable 10mm as per AS1905/1.

### Key Features

- Can provide up to 2 hours fire resistance when fitted to the bottom of proprietary fire doors.
- Non compliant fire doors can be salvaged.
- Avoids expensive door build-ups or door replacements.
- Cost-effective solution.
- Easy retro-fit installation.
- No need to remove the door during installation.

### Use With

Although not required for upgrade work, the Kilargo 4000 Series Threshold Plates may be incorporated as part of the overall system for both aesthetic and disability compliance issues.

### Materials

These products consist of an anodised aluminium profile, flame retardant smoke, draught and light excluding silicone gasket and integral high performance intumescent fire seals.

### Gap Size

- FDBU60-35 Can seal gaps up to 60mm maximum under nom. 35mm proprietary fire doors.
- FDBU60-45 Can seal gaps up to 60mm maximum under nom. 45mm proprietary fire doors.

### Standard lengths

820mm, 920mm, 1220mm

### Standard colours

Clear Anodised (Silver) with grey gaskets

### Fixing

The FDBU60 is supplied with pre-drilled slotted holes and screws for easy application onto the bottom of door leafs. (Aluminium screw-fixed end plates are also available separately).

### Approval/s

- Fully tested to AS1530 Part 4 for up to 2 hours on proprietary fire door assemblies in accordance with AS1905 Part 1
  - Conforms with BCA Specification C3.4 smoke sealing requirements
- NB: Check with your door manufacturer for approvals.

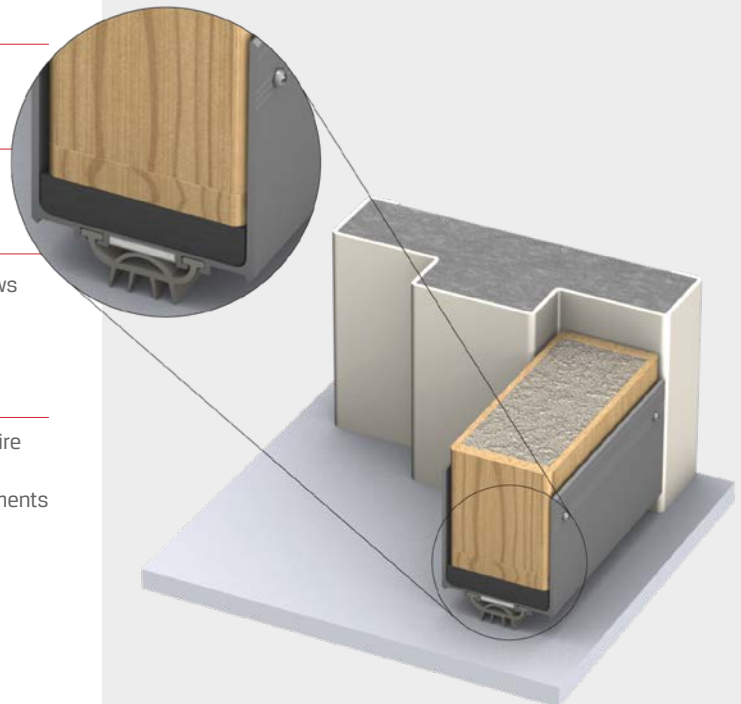
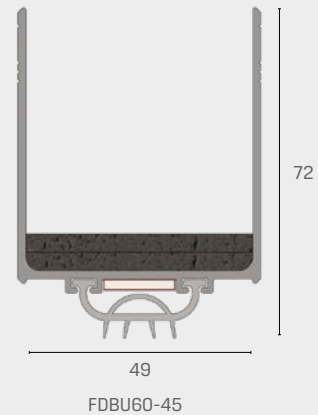
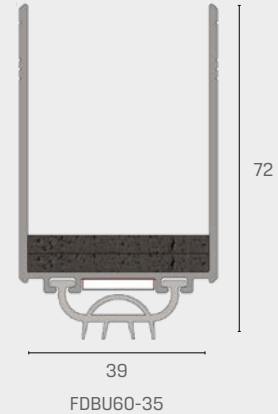

For more product information please scan QR code or visit [www.kilargo.com.au/ourproducts/fdbu60/](http://www.kilargo.com.au/ourproducts/fdbu60/)



All seals proudly manufactured in Australia

## KG4002



Intumescent retro-fit seal for upgrading door perimeter gaps where the clearance exceeds the maximum 3mm specified by AS1905/1. Used to upgrade existing fire doors with up to and including 6mm perimeter gaps.

### Key Features

- Can provide up to 2 hours fire resistance on proprietary fire doors.
- Non compliant fire doors can be salvaged.
- Cost-effective solution.
- Easy retro-fit installation.
- Ideal for fire engineered solutions where extra protection is necessary for life safety.

### Use With

Used in conjunction with a Kilargo Fire Door Bottom Upgrade seal FDBU20/60 to upgrade doors to comply with AS1905/1.

### Materials

Consists of a flame retardant PVC top hat section, encapsulating a high performance intumescent material and two rows of aggressive self-adhesive tape.

### Gap Size

Up to and including 6mm perimeter gaps.  
(Dependent on fire door type. Please contact our Technical Department for relevant test approvals.)

### Sizes

Dimensions: 38mm x 1.6mm

### Standard colours

White, Silver  
Can be painted on-site

### Fixing

The KG4002 intumescent seal is simply applied to the top and sides of the door frame with two rows of aggressive self-adhesive tape. No screw fixing required.

### Approval/s

- Fire tested to AS1530 Part 4 for up to 2 hours on proprietary fire doors in accordance with AS1905 Part 1

Note: Please check with our Technical Department or the Fire Door Manufacturer for relevant test approvals and suitability for door type.

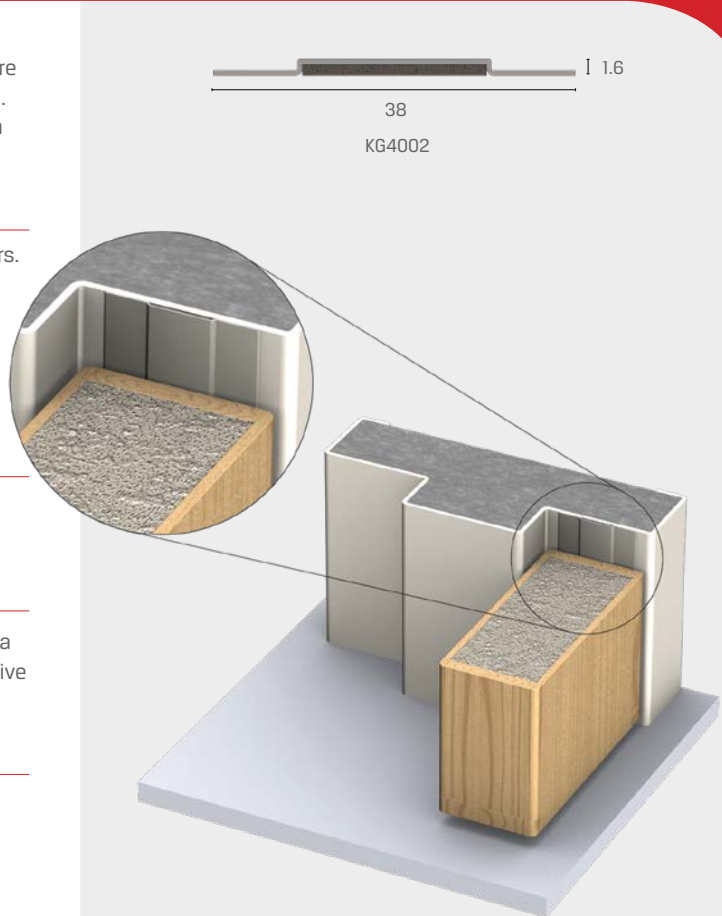

For more product information please scan QR code or visit [www.kilargo.com.au/ourproducts/kg4002/](http://www.kilargo.com.au/ourproducts/kg4002/)



All seals proudly manufactured in Australia

## KG5102



Low-profile intumescent perimeter seal set designed to upgrade existing proprietary fire doors. Allows for a cost-effective and clean build-up of non-rated steel frames with only 15mm stops, in lieu of the conventional 25mm stops required for fire doors.

### Key Features

- Can provide up to 2 hours fire resistance on proprietary fire doors.
- Non compliant fire doors can be salvaged.
- Cost-effective solution.
- Easy retro-fit installation.
- Ideal for fire engineered solutions where extra protection is necessary for life safety.

### Use With

Used in conjunction with a Kilargo Fire Door Bottom Upgrade seal FDBU20/60 to upgrade doors to comply with AS1905/1.

### Materials

Consists of 2 x purpose-designed flame retardant PVC top hat sections, encapsulating intumescent material, with aggressive self-adhesive backing tape.

### Gap Size

Nominal 2mm to 3mm perimeter gaps.

### Sizes

Dimensions: 1 x (38mm x 1.6mm)  
1 x (13mm x 1.6mm)

### Standard colours

White, Grey  
Can be painted on-site

### Fixing

The KG5102 intumescent seal set is simply applied to the top and sides of the door frame with rows of aggressive self-adhesive tape. No screw fixing required.

### Approval/s

- Fire tested to AS1530 Part 4 for up to 2 hours on proprietary fire doors in accordance with AS1905 Part 1

Note: Please check with our Technical Department or the Fire Door Manufacturer for relevant test approvals and suitability for door type.

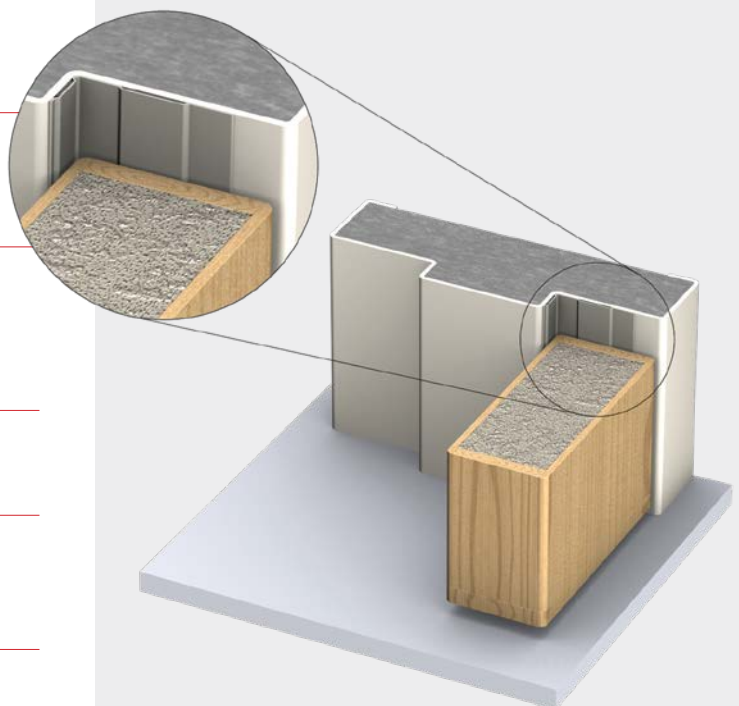
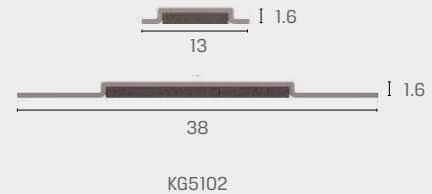

For more product information please scan QR code or visit [www.kilargo.com.au/ourproducts/kg5102/](http://www.kilargo.com.au/ourproducts/kg5102/)



All seals proudly manufactured in Australia



## IFD-D



The IFD-D series intumescent grilles have been fire tested in accordance to AS1530.4 for up to and including a 2 hour rating with most proprietary fire door assemblies, complying with AS1905.1.

The damper units are slimline with an overall thickness of only 35mm allowing them to be flush-fitted within conventional 37 and 47mm nominal fire door leaves. They are easily installed in new or existing fire doors and have no moving parts, resulting in a robust, trouble-free installation which will not rattle or vibrate during door operation.

The IFD-D intumescent fire damper kit comes complete with a pair of decorative face-fixed powder coated cover grilles that provide a clean, neat appearance, plus a tube of Kilargo fire-rated mastic.

### Sizes

Standard door kit sizes:

- 300mm x 300mm
- 450mm x 450mm
- 600mm x 300mm
- 600mm x 600mm

### Standard Colour

Powder-coated silver cover grilles.

### Fixing

The IFD-D damper cell is centred into the prescribed door cut-out and held in place with Kilargo intumescent mastic. The decorative cover grilles are then secured to both sides of the door leaf with screws provided.

### Approvals

- AS1530/4 fire tests with proprietary fire doors providing up to 2 hours fire resistance.
- Complies with AS1905/1

Note: Please check with our Technical Department or the Fire Door Manufacturer for relevant test approvals and suitability for door type.

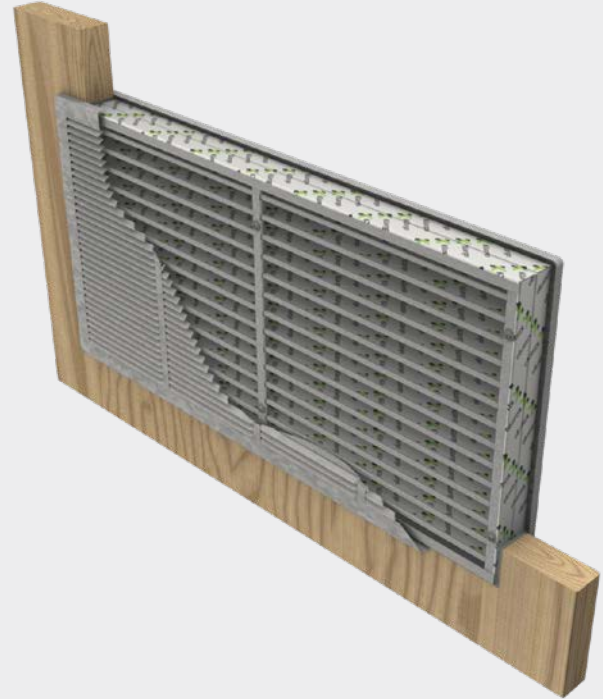

For more product information please scan QR code or visit [www.kilargo.com.au/ourproducts/ifd-d/](http://www.kilargo.com.au/ourproducts/ifd-d/)



All seals proudly manufactured in Australia



For more information, contact your local Kilargo Sales Representative

☎ 1300 858 010 ✉ [info@kilargo.com.au](mailto:info@kilargo.com.au) [www.kilargo.com.au](http://www.kilargo.com.au)