



Standard Breakaway features:

EXTERIOR

- Single piece fibreglass sandwich panel roof
- Insulation to walls & ceilings
- Dometic windows with blinds & flyscreens
- 4 point locking security door
- 2 jerry can holders (inc heavy duty bumper bar)
- Large front storage boot
- Full front window protector
- Superior aluminium wall frame with bracing gussets (no timber rot)
- External power point & annexe light
- Entry door handle with light
- Lockable water filler
- Grey Water Tank
- Front grab handles
- LED Lights
- Roll out awning
- Aluminium checkerplate to front & sides
- Underfloor metal sheeting
- Wheel arch brush stoneguard protector
- 100ah battery & charger
- Solar panel pack
- Tool box with generator slide out
- Pull out door step
- Breakaway safety system
- Twin gas bottles with change over regulator
- Drop down picnic table
- External speakers
- Bike rack
- Front stone guard protector
- External Shower
- Two 95 Litre fresh water tanks

INTERIOR

- Easy lift pop top roof
- Gas struts & scissor arms for pop tops
- Water resistant laminates to all bench & table tops
- Quality floor vinyls
- Queen bed with lift up gas struts
- Gas/electric hot water system
- Exhaust fan in shower
- Water filter + tap
- Large stainless steel sink with cover board
- Grill with 4 gas
- 12V rangehood with external exhaust
- Microwave oven
- Electrical - earth leakage safety switch, double power points in kitchen & dinette & beds
- Smoke alarm for your safety
- Fire extinguisher
- Choice of 3 way or compressor fridge
- Flat screen TV (24inch)
- DVD/radio system
- Air conditioner
- Top Load Washing machine

CHASSIS

- Hot dipped galvanised chassis
- Galvanised drop step checker plate lined
- Alko quick release drop down jacks & heavy duty jockey wheel
- Jacking points for lifting jack placement
- Galvanised heavy duty bumper
- Galvanised water tank protector
- Mains tap to A frame & mains pressure
- Cruisemaster XT independent all-terrain suspension system
- D035 Coupling
- 17" Wheels & Tyres

OPTIONAL UPGRADES

- Slide out kitchen
- Tic cushion & table leg
- Reversing camera
- Full oven with four gas
- Dishwasher
- Wine cooler
- Satellite dish
- Aluminium composite smooth exterior panel finish

Other options and upgrades available on request.

Note: Specifications may change at anytime without notice, due to continuous improvement. Photographs are for illustration purposes only and non standard options may be shown.

The Millard BREAKAWAY

AUSTRALIAN MADE
AUSTRALIAN OWNED
AUSTRALIAN TOUGH
FOR OVER 70 YEARS



*Picture is for illustration only and may contain optional items

Your Local Millard Dealer

MILLARD
caravans

Dealers Licence MD074159 Repairers Licence MDRL56206

www.millardrv.com.au

www.facebook.com/millardcaravans

Millard is a member of the Recreational Vehicle Manufacturing Accreditation Program (RVMAP) and all their caravans come with a 12 month Australia - Wide Warranty

The only choice for the great Aussie outdoors

Millard Caravans manufacture semi off-road and full off-road model caravans that are built to endure our harsh Australian conditions. With a hot dipped galvanised chassis, aluminium frame and Cruise Master Independent suspension system, the strength and durability of our vans are made to last.

The Breakaway is available in full van, bunk and pop-top models, all built in house from the chassis up. The vans are equipped with the latest appliances, safety features and luxury items to make your holiday the most comfortable and enjoyable experience. With over 70 years of experience, Millard Caravans ensure that your van is built to suit your individual needs.

MILLARD
caravans

LAYOUTS

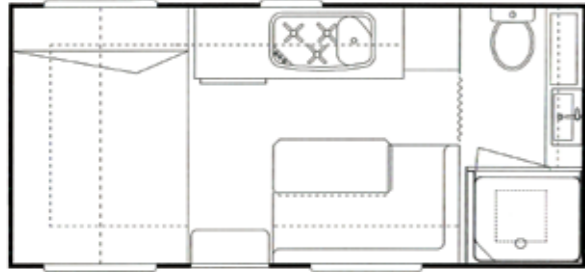

15'6" x 7' FD SHOWER

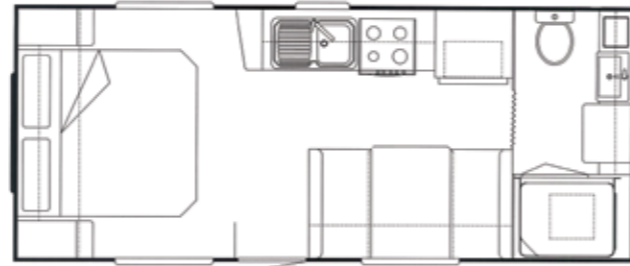

18'6" x 7'8" C/D SHOWER

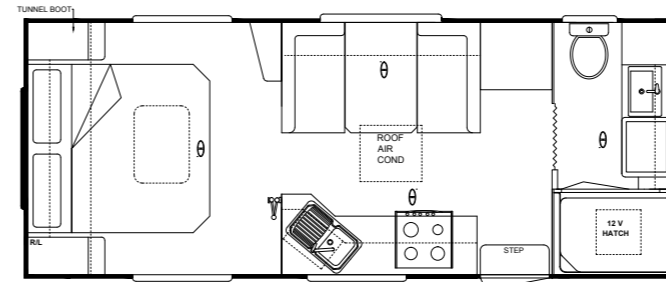

19'6" x 7'8" RD CARAVAN SHOWER

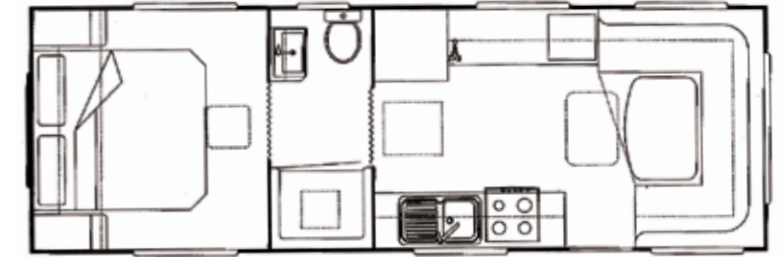

23' x 7'8" RD CLUB LOUNGE SHOWER

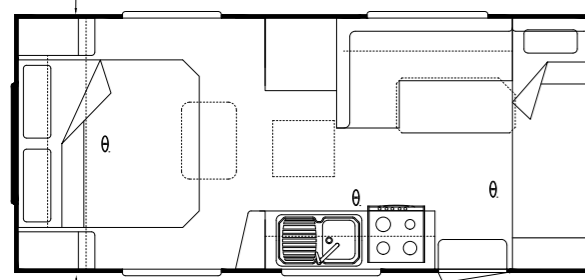

17'6" x 7'8" BUNKS



19' x 7'8" RD SB SHOWER

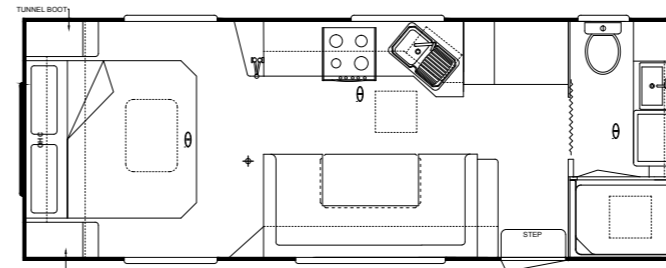

21' x 7'8" RD CLUB LOUNGE SHOWER

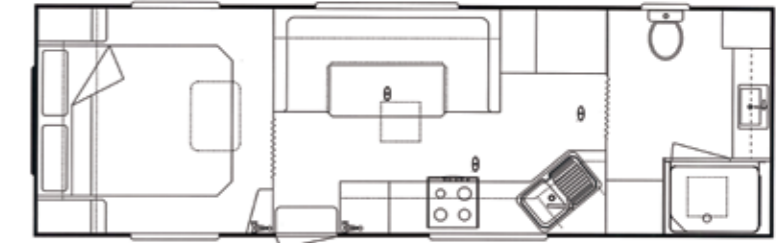

24'6" x 7'8" FD CLUB LOUNGE SHOWER

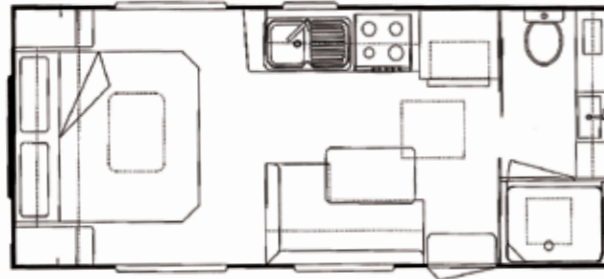

17'6" x 7'8" RD SHOWER

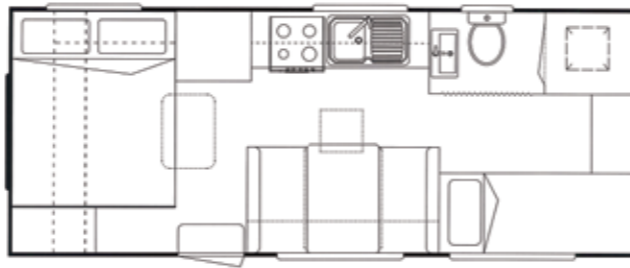

19'6" x 7'8" F/D BUNKS SHOWER

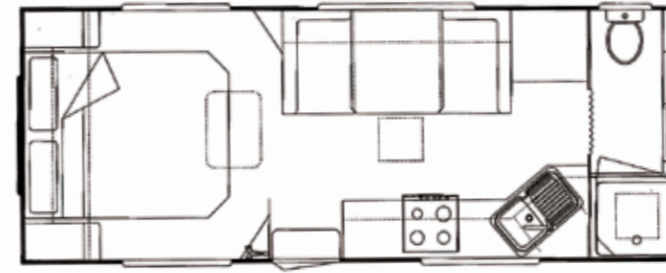

21' x 7'8" CD SHOWER

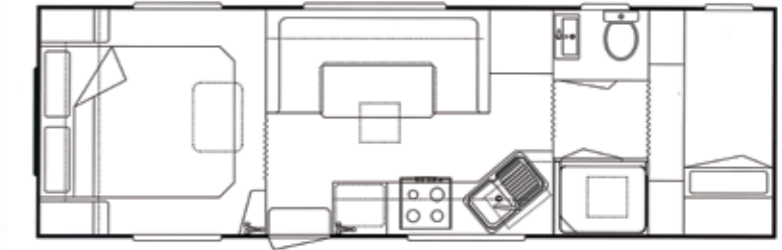

24'6" x 7'8" FD CLUB LOUNGE SHOWER BUNKS

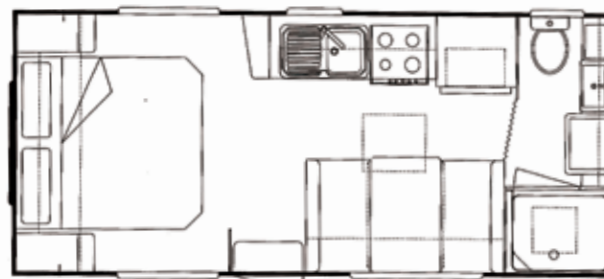

17'6" x 7'8" CD SHOWER

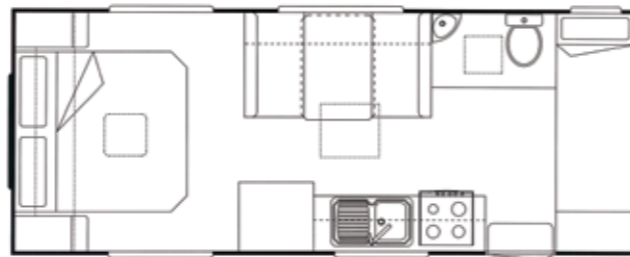

19'6" x 7'8" RD BUNKS SHOWER

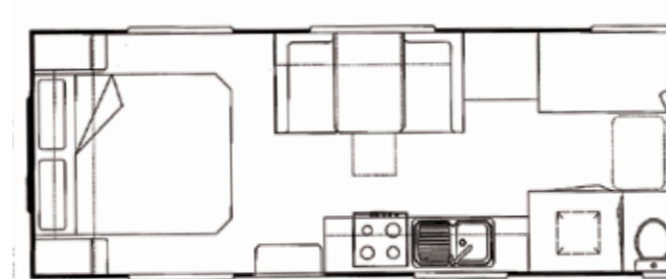

22' x 7'8" CD BUNKS SHOWER



VANS UP TO AND INCLUDING 17'6" LONG ARE SINGLE AXLE, 18' AND UP ARE DUAL AXLE

ALL ITEMS WHETHER STANDARD OR OPTIONAL EXTRAS ARE SUBJECT TO CHANGE WITHOUT NOTICE, NO GUARANTEE OF BRAND IS OFFERED OR IMPLIED, ALL PHOTOS ARE FOR DISPLAY ONLY AND THE DISPLAY ITEMS IN THE PHOTO ARE NOT INCLUDED, UNLESS SPECIFICALLY NOTED ON CONTRACT OR PROMISE SHEET. LAYOUTS ARE SUBJECT TO CHANGES AND UPDATES, NOT ALL OPTIONS ARE AVAILABLE ON ALL LAYOUTS. COLOUR COMPONENTS AND MATERIALS ARE SUBJECT TO CHANGE DUE TO PRODUCT IMPROVEMENT, DISCONTINUANCE OF ITEM OR CHANGE OF SUPPLIER. MILLARD CARAVANS ARE DESIGNED FOR RECREATIONAL USE ONLY. WARRANTY MAY NOT APPLY FOR COMMERCIAL OR RESIDENTIAL USE. MILLARD CARAVANS DO NOT SUPPLY ON SITE WARRANTY. FOR WARRANTY CLAIMS THE CARAVAN MUST BE RETURNED TO AN AUTHORISED SERVICE AGENT. INDIVIDUAL ITEMS FITTED TO YOUR CARAVAN ARE BACKED BY THEIR OWN WARRANTIES. THE CARAVAN MUST BE TAKEN TO AN AUTHORISED REPAIR AGENT FOR WARRANTY CLAIMS TO BE RECTIFIED. CLADDING AND ROOF MAY SUFFER FROM SOME VISIBLE DISTORTION AND BUCKLING IN EXTREME TEMPERATURES. THIS IS A NORMAL PROCESS AND IS NOT A WARRANTABLE ITEM. 1.3.16